

RB6042



Incremental encoder with solid shaft

RB-0100-I24/L4

Article no longer available - archive entry

Alternative article: RB3500 When selecting an alternative article and accessories please note that technical data may differ! –
When selecting an alternative article and accessories please note that technical data may differ! – Discontinuation date: 31.03.2016

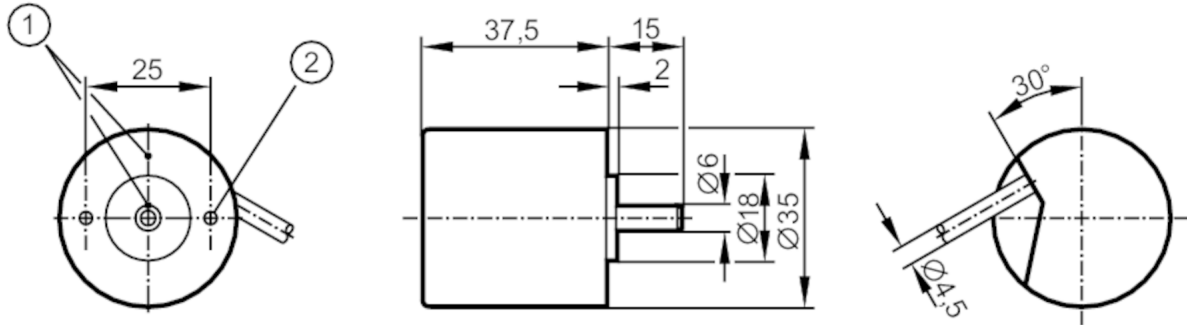

- 1 reference mark
- 2 M3 Depth 5 mm



Product characteristics

| | |
|---------------------|----------------|
| Resolution | 100 resolution |
| Shaft design | solid shaft |
| Shaft diameter [mm] | 6 |

Application

| | |
|--------------------|-------------|
| Function principle | incremental |
|--------------------|-------------|

Electrical data

| | |
|--------------------------|------------|
| Operating voltage [V] | 10...30 DC |
| Current consumption [mA] | 150 |

Outputs

| | |
|-----------------------------------|--------|
| Electrical design | HTL |
| Max. current load per output [mA] | 50 |
| Switching frequency [kHz] | 160 |
| Type of short-circuit protection | < 60 s |
| Phase difference A and B [°] | 90 |

Measuring/setting range

| | |
|------------|----------------|
| Resolution | 100 resolution |
|------------|----------------|

Operating conditions

| | |
|--------------------------------|---------------------|
| Ambient temperature [°C] | -30...70 |
| Max. relative air humidity [%] | 75; (briefly: 95 %) |
| Protection | IP 64 |

RB6042



Incremental encoder with solid shaft

RB-0100-I24/L4

| Tests / approvals | | |
|----------------------|---------|---------------------|
| Shock resistance | | 100 g (6 ms) |
| Vibration resistance | | 10 g (55...2000 Hz) |
| MTTF | [years] | 190 |

| Mechanical data | | |
|---|---------|-----------------|
| Weight | [g] | 553.6 |
| Dimensions | [mm] | Ø 35 / L = 52.5 |
| Materials | | aluminium |
| Max. revolution, mechanical | [U/min] | 10000 |
| Max. starting torque | [Nm] | 1 |
| Reference temperature torque | [°C] | 20 |
| Shaft design | | solid shaft |
| Shaft diameter | [mm] | 6 |
| Shaft material | | steel (1.4104) |
| Max. shaft load axial (at the shaft end) | [N] | 5 |
| Max. shaft load radial (at the shaft end) | [N] | 10 |

| Remarks | |
|---------|----------------------|
| Notes | discontinued article |

Electrical connection

Cable: 4 m, PUR; radial, can also be used axially

| | |
|-------------|------------------|
| brown | A |
| green | A V A |
| grey | B |
| pink | 0 V B |
| red | 0 index |
| black | 0 V 0 index |
| brown/green | L+ (Up) |
| white/green | L- 0 V (Un) |
| lilac | failure inverted |
| screen | housing |

Diagrams and graphs

| | |
|---------------|--|
| Pulse diagram | <p>Output A Output B 0 index</p> |
|---------------|--|

Article no longer available - archive entry

RB6042



Incremental encoder with solid shaft

RB-0100-I24/L4

Alternative article: RB3500 When selecting an alternative article and accessories please note that technical data may differ! –
When selecting an alternative article and accessories please note that technical data may differ! – Discontinuation date: 31.03.2016