

# IT5039

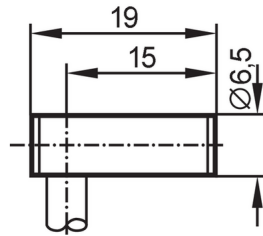

## Inductive sensor

ITB3002-BPKG/2M PVC



Product characteristics		
Electrical design		PNP
Output function		normally open
Sensing range	[mm]	2
Housing		cylindrical
Dimensions	[mm]	Ø 6.5 / L = 19
Electrical data		
Operating voltage	[V]	10...30 DC
Current consumption	[mA]	20; (24 V)
Reverse polarity protection		yes
Outputs		
Electrical design		PNP
Output function		normally open
Max. voltage drop switching output DC	[V]	2.5
Permanent current rating of switching output DC	[mA]	200
Switching frequency DC	[Hz]	1000
Short-circuit protection		yes
Type of short-circuit protection		pulsed
Overload protection		no
Detection zone		
Sensing range	[mm]	2
Real sensing range Sr	[mm]	2 ± 10 %
Operating distance	[mm]	0...1.6
Accuracy / deviations		
Correction factor		steel: 1 / stainless steel: 0.7 / brass: 0.4 / aluminium: 0.3 / copper: 0.2
Hysteresis	[% of Sr]	< 15
Switch point drift	[% of Sr]	-10...10
Operating conditions		
Ambient temperature	[°C]	-25...70
Protection		IP 67
Tests / approvals		
EMC	EN 60947-5-2	
	EN 55011	class B

# IT5039



## Inductive sensor

ITB3002-BPKG/2M PVC

MTTF	[years]	1045
UL approval	Ta	0...40 °C
	voltage supply	Class 2
	File number UL	E174191

### Mechanical data

Weight	[g]	57
Housing		cylindrical
Mounting		flush mountable
Dimensions	[mm]	Ø 6.5 / L = 19
Materials		housing: stainless steel; sensing face: PBT

### Remarks

Pack quantity	1 pcs.
---------------	--------

### Electrical connection

Cable: 2 m, PVC; 3 x 0.14 mm<sup>2</sup>

### Connection

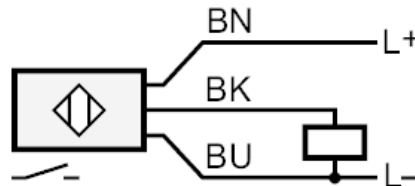

Core colours :  
BK = black  
BN = brown  
BU = blue