

# E80342

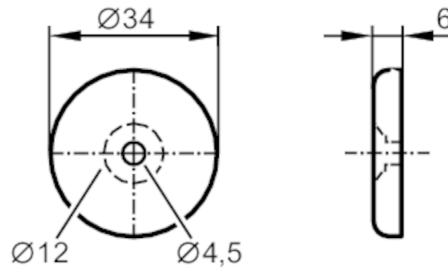

## RFID tag

ID-TAG/34X6.0/06



### Application

Operating temperature (active) [°C]	-40...85
Peak temperature (passive) [°C]	100

### Electrical data

Operating frequency [MHz]	13,56
Memory size [bit]	896
Memory type	EEPROM
Chip type	ICODE SLIX
Number of blocks	28
Block size [Byte]	4
Unique Identification Number (UID) [Byte]	8
RFID standard	ISO 15693
Max. read cycles	unlimited
Max. write cycles	100000

### Operating conditions

Ambient temperature [°C]	-40...85
Storage temperature [°C]	-40...100
Protection	IP 68

### Tests / approvals

Shock resistance	DIN IEC 68-2-27	40 g 18 ms
Vibration resistance	DIN IEC 68-2-6	10 g 10...2000 Hz
Radio approval	ISO 15693	

### Mechanical data

Weight [g]	67.2
Type of mounting	Installation on metal and non-metal materials; (screw fastening ; sticking to a surface)
Dimensions [mm]	Ø 34 / L = 6
Materials	PA 6

### Remarks

Remarks	
Pack quantity	10 pcs.

# E80342



## RFID tag

ID-TAG/34X6.0/06

### Other data

#### Reading distance when mounted on non-metal (mm)

ANT410 / DTI410	6
ANT411 / DTI411	12
ANT420 / DTI420 / DTM424 / DTI424 / DTM426	6
ANT421 / DTI421 / DTM425 / DTI425 / DTM427	25
ANT430 / DTI430 / DTM434 / DTI434 / DTM436	20
ANT431 / DTI431 / DTM435 / DTI435 / DTM437	30
ANT513 / DTI513 / DTC510	45
ANT515 / DTI515 / ANT516 / DTI516	20
ANT600 / DTI600	-

#### read distance when mounted on metal (mm)

ANT410 / DTI410	5
ANT411 / DTI411	10
ANT420 / DTI420 / DTM424 / DTI424 / DTM426	5
ANT421 / DTI421 / DTM425 / DTI425 / DTM427	25
ANT430 / DTI430 / DTM434 / DTI434 / DTM436	10
ANT431 / DTI431 / DTM435 / DTI435 / DTM437	25
ANT513 / DTI513 / DTC510	40
ANT515 / DTI515 / ANT516 / DTI516	15