

E21095

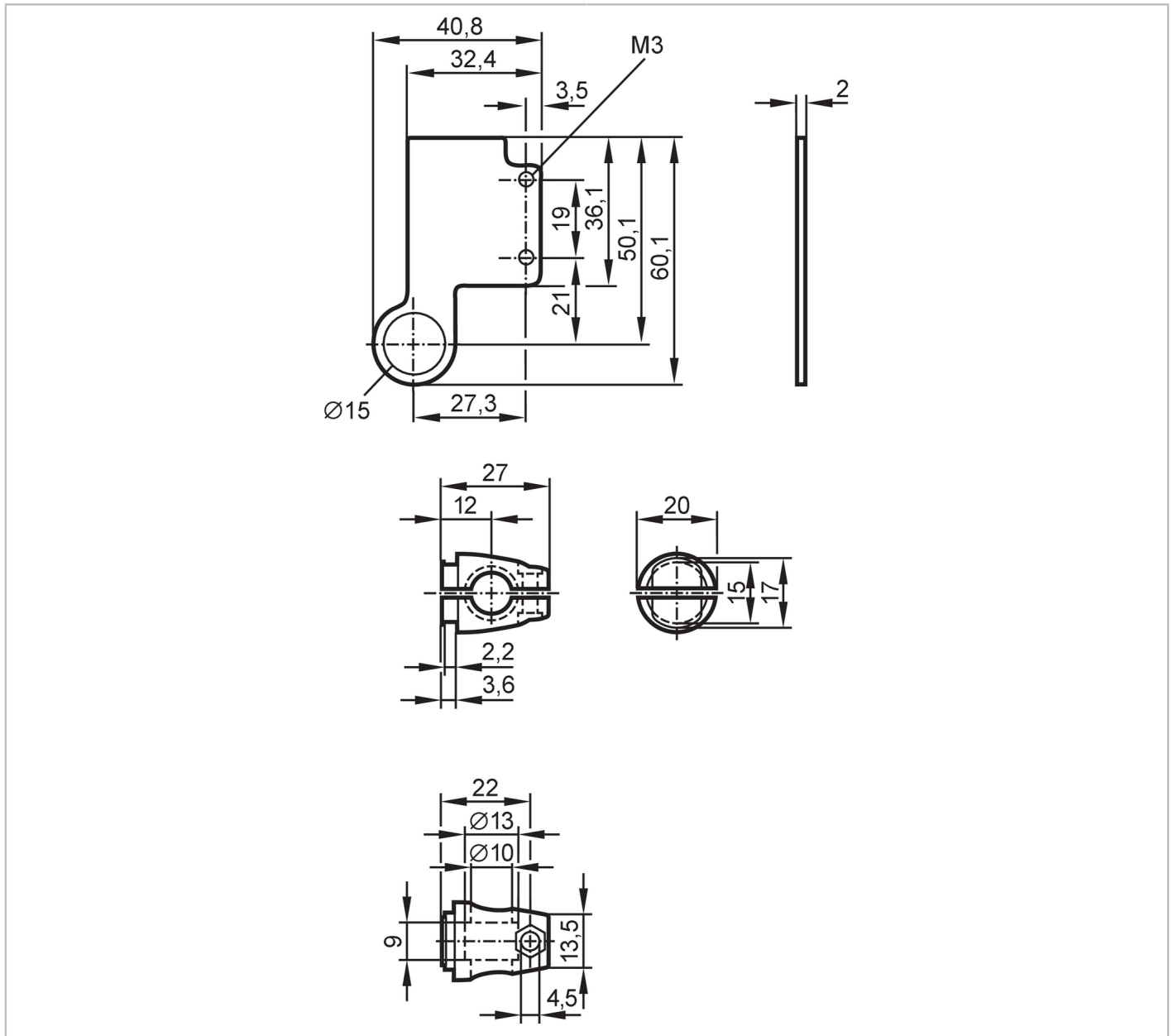

Mounting set for photoelectric sensors

SYSTEM COMPONENT OJ ROD



Application	
Design	for side lens, clamp mounting, for types, OJ
Mechanical data	
Weight [g]	59.5
Type of mounting	Mounting rod; (Ø 10 mm)
Materials	Clamp: diecast zinc; fixture: stainless steel (316Ti/1.4571)
Accessories	
Items supplied	screws: 1 x (M4 x 12 mm) Nuts: 1 x M4
Remarks	
Pack quantity	1 pcs.