

# E20720

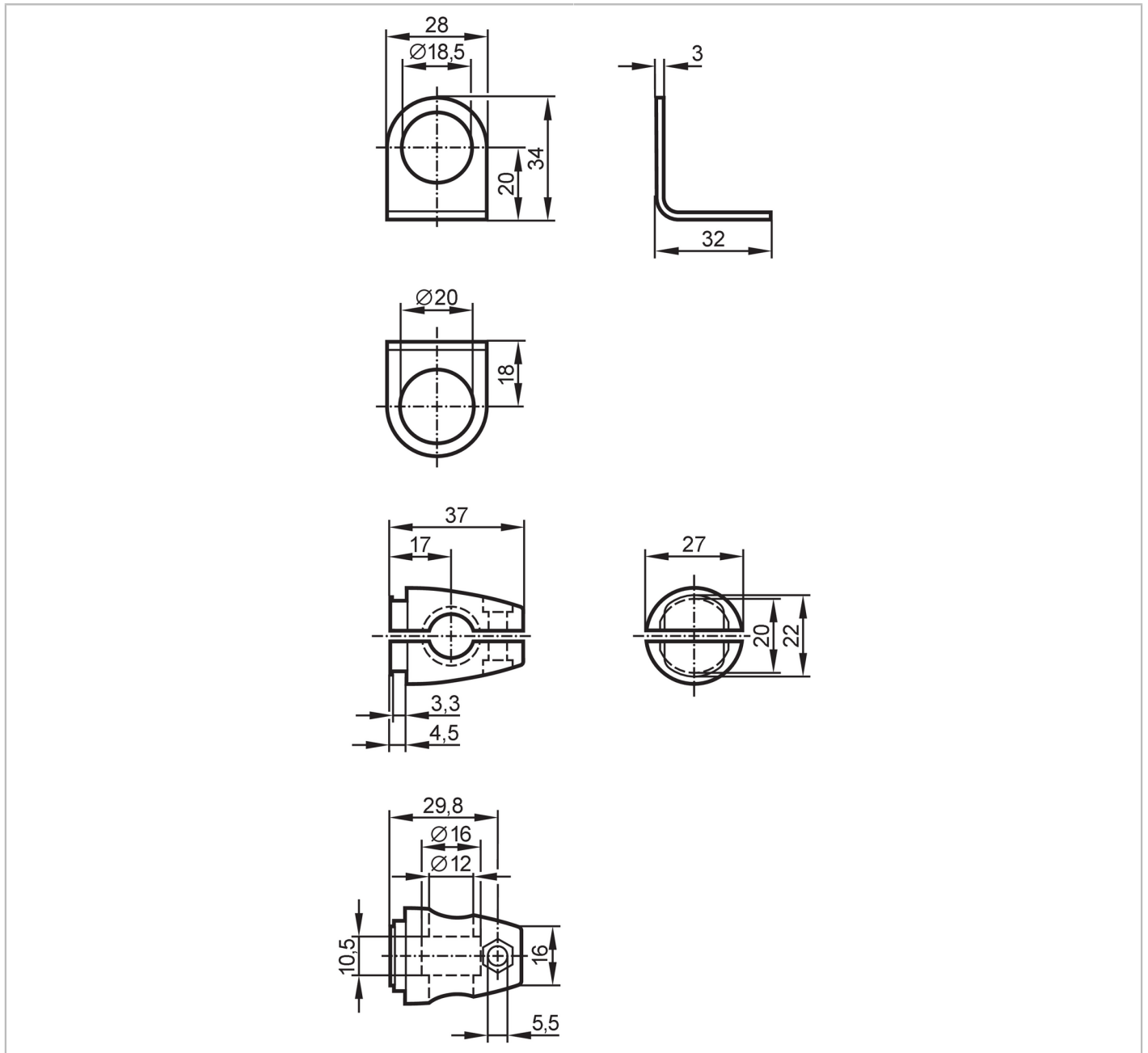

## Mounting set for position sensors

MOUNTING SET 1 ROD MOUNTING



Application	
Design	clamp mounting, for types, M18
Mechanical data	
Weight [g]	104.5
Type of mounting	Mounting rod; ( $\varnothing 12$ mm)
Dimensions [mm]	$\varnothing 18.5$
Materials	Clamp: diecast zinc; fixture: steel
Remarks	
Pack quantity	1 pcs.