

## Through-beam sensor transmitter

O6S-OOKG/0,30m/US

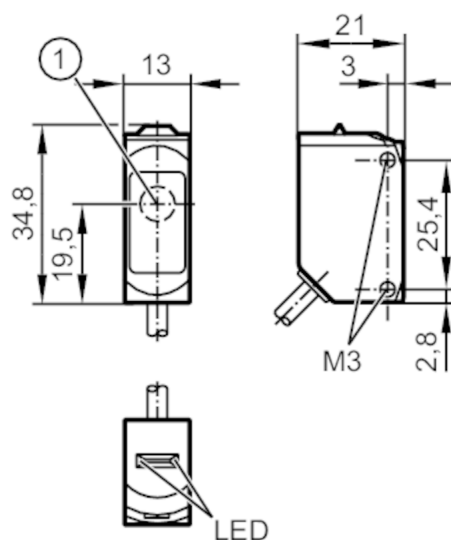

1: light emission



## Product characteristics

Type of light	red light
Housing	rectangular

## Application

Function principle	Through-beam sensor
--------------------	---------------------

## Electrical data

Operating voltage	[V]	10...30 DC
Current consumption	[mA]	11; ((24 V))
Protection class		III
Type of light		red light
Wave length	[nm]	633

## Detection zone

Transmitter / receiver		transmitter
Range	[m]	< 10
Max. light spot diameter	[mm]	300
Light spot dimensions refer to		at maximum range

## Operating conditions

Ambient temperature	[°C]	-25...80
Protection		IP 65; IP 67; IP 68; IP 69K

## Tests / approvals

EMC		EN 60947-5-2
MTTF	[years]	2600
UL approval		UL Approval no. E005

## Mechanical data

Weight	[g]	50.5
--------	-----	------

# O6S301



## Through-beam sensor transmitter

O6S-OOKG/0,30m/US

Housing	rectangular
Dimensions [mm]	34.8 x 13 x 21
Materials	housing: stainless steel (316L/1.4404); plastics: PPSU; Sealing: EPDM
Lens material	PMMA
Lens alignment	side lens

### Displays / operating elements

Display	operation	1 x LED, green
---------	-----------	----------------

### Remarks

Remarks	operating voltage "supply class 2" according to cULus
Pack quantity	1 pcs.

### Electrical connection

Cable: 0.3 m, PVC; 2 x 0.25 mm<sup>2</sup>

Connector: 1 x M12; coding: A



### Connection

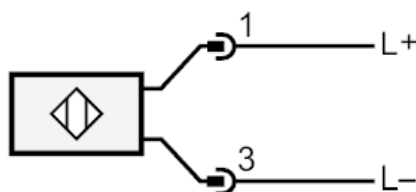

## Through-beam sensor transmitter

O6S-OOKG/0,30m/US

### Diagrams and graphs

excess gain graph

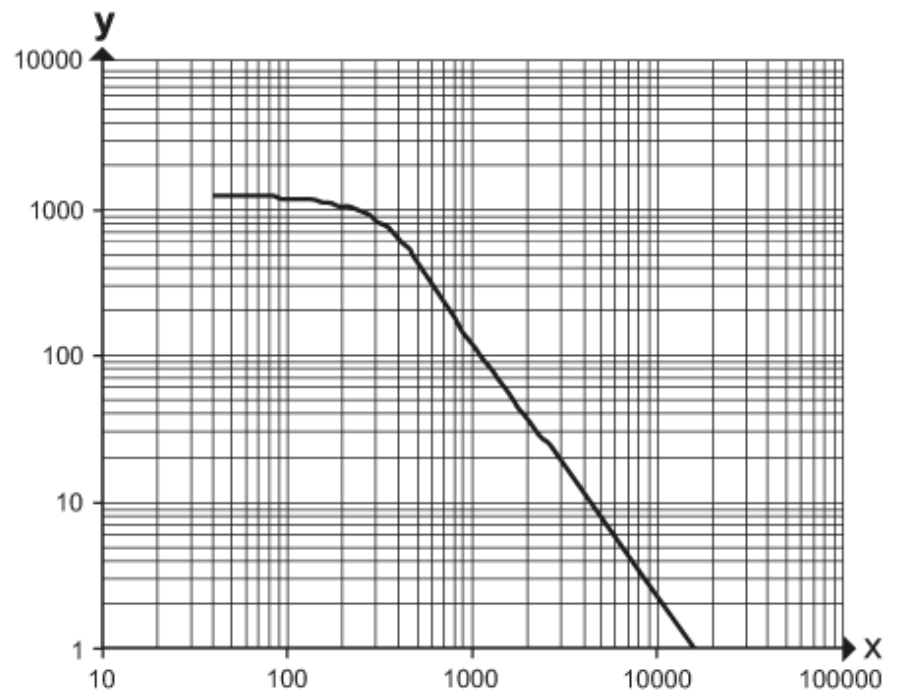

x: distance [mm]

y: excess gain factor