

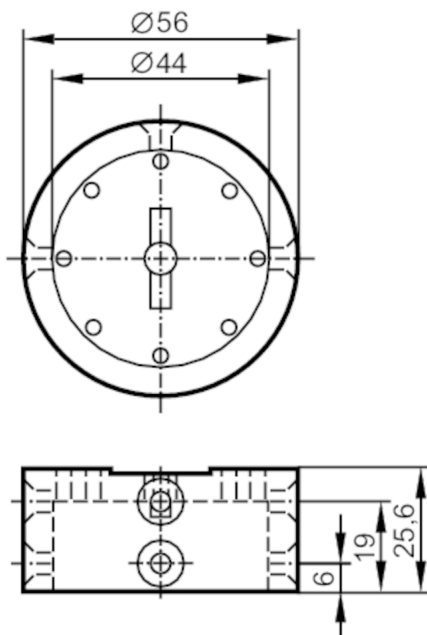

## Target puck for valve actuators

PUCK, PKG, UNV, TYPE 2



### Application

Design for mechanical interfaces to pneumatic actuators or manually-operated valves

### Mechanical data

Weight [g]	113.398
Target puck diameter [mm]	56
Number of possible switching flag positions	6
Material	Target puck: HDPE black; puck mounting screw: stainless steel M6 x 35 mm; sensor mounting screws: stainless steel 10 - 24 x 1 3/4"

### Accessories

Items supplied	countersunk screws: 3, HDPE
	countersunk screws: 3 x 10-32 x 1/4", stainless steel
	counter-sunk screw: 1 x M5 x 35 mm, stainless steel
	washers: 2, stainless steel
	panhead screws: 2 x 10-24 x 1 1/4", stainless steel
	panhead screws: 2 x 10-32 x 3/4"
	panhead screws: 2 x M5 x 45 mm
	target puck adapter: 1 x 10 mm, HDPE
	Spacer: 1 x 10 mm
	direction indication: 1, HDPE yellow

### Remarks

Pack quantity	1 pcs.
---------------	--------