

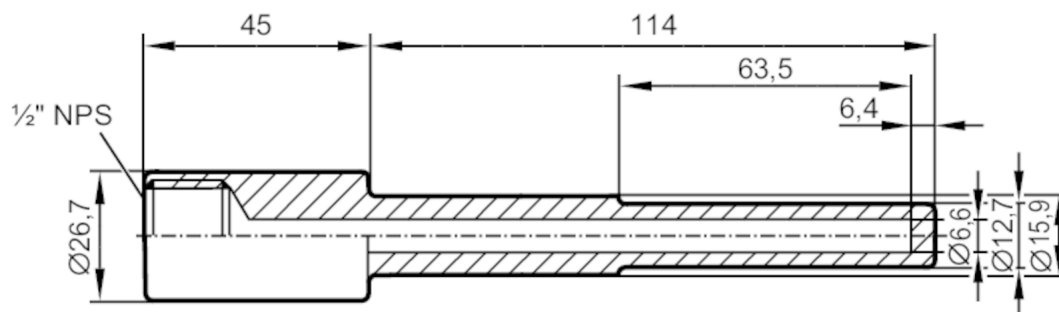

Thermowell for temperature sensors

THWL, 6MM X 4.5", 3/4" WELD



Application

Design	for temperature sensors EL = 150 mm
Pressure rating [bar]	400

Accuracy / deviations

Max. permissible flow velocity [m/s]	25
--------------------------------------	----

Mechanical data

Weight [g]	293.928
Material	stainless steel (1.4404 / 316L)
Sensor connection	1/2" NPS Ø 6 mm suitable for G1/2 and 1/2" NPT
Process connection	Welding adapter
Installation length EL [mm]	114
Bore length BL [mm]	152.6

Remarks

Pack quantity	1 pcs.
---------------	--------