

Control monitor for flow sensors

VS0200/110VAC

Article no longer available - archive entry

Alternative articles: SN0150

When selecting an alternative article and accessories please note that technical data may differ!

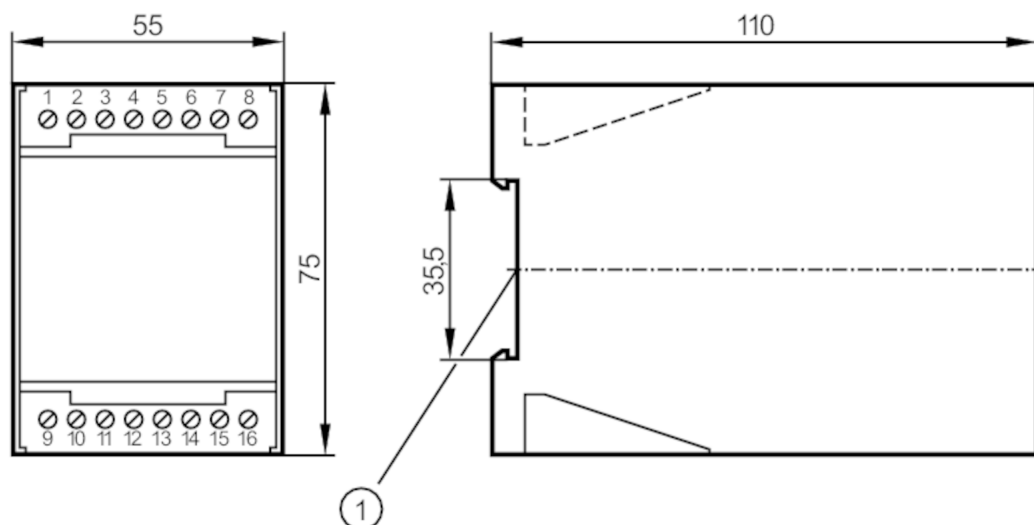

1 Mounting on DIN rail



Application

Application	Flow monitoring
-------------	-----------------

Electrical data

Operating voltage tolerance	[%]	-10...10
Operating voltage	[V]	< 110 AC
Power-on delay time	[s]	30
Number of channels		1

Outputs

Electrical design	Relay
Switching function flow monitoring	relay energized when flow is present

Software / programming

Adjustment of the switch point	potentiometer
Selection liquids / gases	with slide switch

Operating conditions

Ambient temperature	[°C]	0...60
Protection		IP 40
Protection rating terminals		IP 20

Mechanical data

Housing	housing for DIN rail mounting	
Dimensions	[mm]	75 x 55 x 110

SY0100



Control monitor for flow sensors

VS0200/110VAC

Material	plastics	
Displays / operating elements		
Display	Function	11 x LED
Remarks		
Pack quantity	1 pcs.	

Electrical connection

terminals: 16 x ...2.5 mm²

Connection

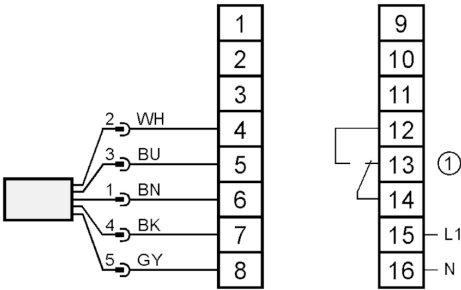

- 1: Relais Flow monitoring
Core colors :
- BN = brown
BU = blue
BK = black
WH = white
GY = grey