

# ST4300



## Flow sensor for connection to an evaluation unit

STR34ZBB

Article no longer available - archive entry

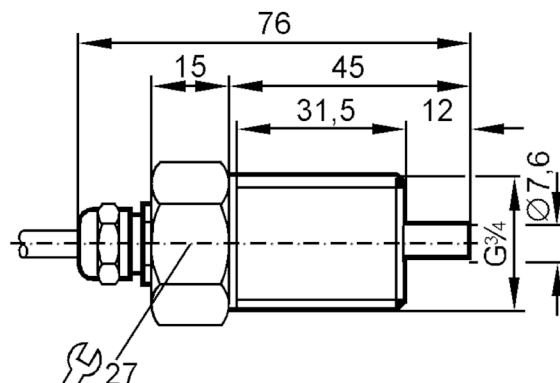

### Product characteristics

Process connection	G 3/4 external thread
--------------------	-----------------------

### Application

Application	high temperature
Media	Liquids; Gases
Pressure rating [bar]	30

### Liquids

Application	high temperature
Medium temperature [°C]	0...120

### Gases

Medium temperature [°C]	0...100
-------------------------	---------

### Electrical data

Connection to control monitor	VS 0100
-------------------------------	---------

### Measuring/setting range

#### Liquids

Setting range [cm/s]	3...300
Greatest sensitivity [cm/s]	3...60

#### Gases

Setting range [cm/s]	5...1500
----------------------	----------

### Accuracy / deviations

Max. temperature gradient of [K/min] medium	15
---	----

### Reaction times

Response time [s]	1...10
-------------------	--------

# ST4300



## Flow sensor for connection to an evaluation unit

STR34ZBB

Liquids		
Response time	[s]	1...10
Gases		
Response time	[s]	1...10
Operating conditions		
Protection		IP 67
Mechanical data		
Housing		Threaded type
Material		stainless steel (1.4571/316Ti )
Process connection		G 3/4 external thread
Remarks		
Pack quantity		1 pcs.
Electrical connection		
Cable: 2 m, silicone; Maximum cable length: 100 m; 4 x 0.5 mm <sup>2</sup>		
Connection		

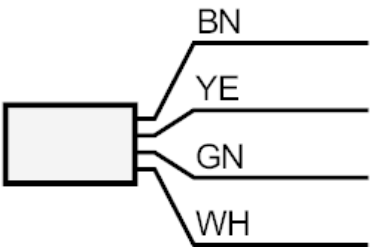

	Core colors :
BK =	black
BN =	brown
BU =	blue
WH =	white