

ST3000



Flow sensor for connection to an evaluation unit

STR12ABA

Article no longer available - archive entry

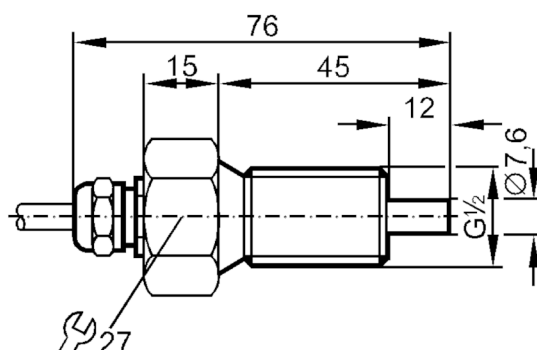

Product characteristics

Process connection	G 1/2 external thread
--------------------	-----------------------

Application

Application	high temperature
Media	Liquids; Gases
Medium temperature [°C]	-25...80
Pressure rating [bar]	30

Liquids

Application	high temperature
Medium temperature [°C]	-25...80

Gases

Medium temperature [°C]	-25...80
-------------------------	----------

Electrical data

Connection to control monitor	VS 0100
-------------------------------	---------

Measuring/setting range

Liquids

Setting range [cm/s]	3...300
Greatest sensitivity [cm/s]	3...60

Gases

Setting range [cm/s]	5...15
----------------------	--------

Accuracy / deviations

Max. temperature gradient of medium [K/min]	15
---	----

ST3000



Flow sensor for connection to an evaluation unit

STR12ABA

Reaction times		
Response time	[s]	1...10
Liquids		
Response time	[s]	1...10
Gases		
Response time	[s]	1...10
Operating conditions		
Protection		IP 67
Mechanical data		
Housing		Threaded type
Material		stainless steel (1.4305 / 303)
Process connection		G 1/2 external thread
Remarks		
Pack quantity		1 pcs.
Electrical connection		
Cable: 2 m, Silflex-PUR; Maximum cable length: 100 m; 4 x 0.25 mm ²		
Connection		

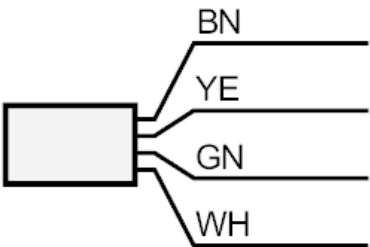

	Core colors :
BN =	brown
WH =	white
YE =	yellow
GN =	green