

ST3658



Flow monitor

SCR12ABBAKOW/LS

Article no longer available - archive entry

Alternative articles: SI5006 + E40096

When selecting an alternative article and accessories please note that technical data may differ!

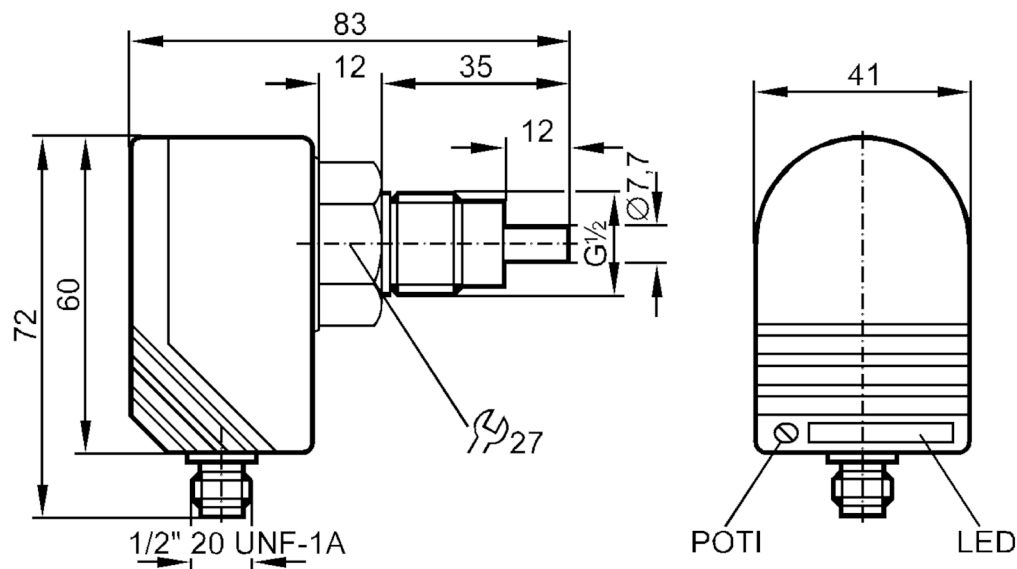

Product characteristics	
Number of inputs and outputs	Number of digital outputs: 1
Process connection	G 1/2 external thread
Application	
Media	Liquids
Medium temperature [°C]	-25...80
Pressure rating [bar]	30
Electrical data	
Operating voltage [V]	80...140 AC
Current consumption [mA]	< 40
Power-on delay time [s]	< 20
Inputs / outputs	
Number of inputs and outputs	Number of digital outputs: 1
Outputs	
Total number of outputs	1
Output signal	switching signal
Number of digital outputs	1
Output function	normally open
Short-circuit protection	no

ST3658



Flow monitor

SCR12ABBAKOW/LS

Overload protection	no	
Measuring/setting range		
Setting range	[cm/s]	3...300
Greatest sensitivity	[cm/s]	3...60
Accuracy / deviations		
Max. temperature gradient of medium	[K/min]	15
Reaction times		
Response time	[s]	1...10
Software / programming		
Adjustment of the switch point	potentiometer	
Operating conditions		
Ambient temperature	[°C]	-25...60
Protection	IP 67	
Mechanical data		
Material	PBT-GF20	
Materials (wetted parts)	stainless steel (1.4571/316Ti)	
Process connection	G 1/2 external thread	
Displays / operating elements		
Display	Function	11 x LED
Accessories		
Items supplied	sealings: 2 x AMF 30	
	screwdrivers	
Remarks		
Pack quantity	1 pcs.	

Electrical connection

Connector: 1 x 1/2"; coding: C

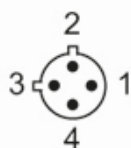

ST3658

Flow monitor

SCR12ABBAKOW/LS



Connection

