

ST3400



Flow sensor for connection to an evaluation unit

STR12AAC

Article no longer available - archive entry

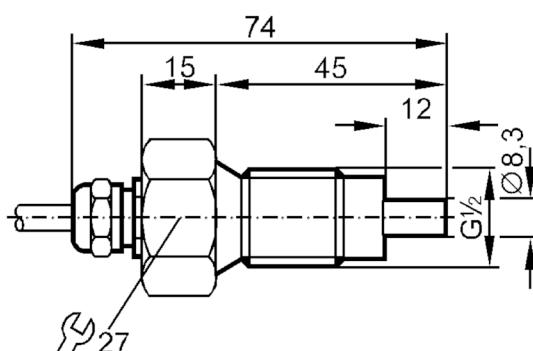

Product characteristics

Process connection	G 1/2 external thread
--------------------	-----------------------

Application

Media	Liquids; aggressive media
-------	---------------------------

Medium temperature	[°C]	-25...80
--------------------	------	----------

Pressure rating	[bar]	5
-----------------	-------	---

Liquids

Medium temperature	[°C]	-25...80
--------------------	------	----------

Electrical data

Connection to control monitor	VS 0100
-------------------------------	---------

Measuring/setting range

Liquids

Setting range	[cm/s]	3...300
---------------	--------	---------

Greatest sensitivity	[cm/s]	3...60
----------------------	--------	--------

Accuracy / deviations

Max. temperature gradient of medium	[K/min]	15
-------------------------------------	---------	----

Reaction times

Response time	[s]	2...20
---------------	-----	--------

Liquids

Response time	[s]	2...20
---------------	-----	--------

Operating conditions

Protection	IP 67
------------	-------

ST3400



Flow sensor for connection to an evaluation unit

STR12AAC

Mechanical data	
Housing	Threaded type
Material	PTFE
Process connection	G 1/2 external thread

Remarks	
Pack quantity	1 pcs.

Electrical connection	
Cable: 2 m, Silflex-PUR; Maximum cable length: 100 m; 4 x 0.25 mm²	

Connection

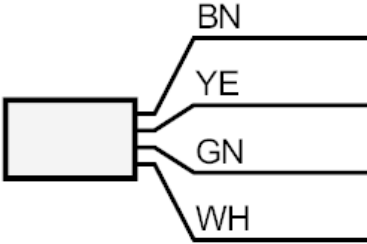

BN
YE
GN
WH

BN =

WH =

YE =

GN =

Core colors :

brown

white

yellow

green