

ST2200



Flow sensor for connection to an evaluation unit

STR14ABB

Article no longer available - archive entry

Alternative articles: ST2204

When selecting an alternative article and accessories please note that technical data may differ!

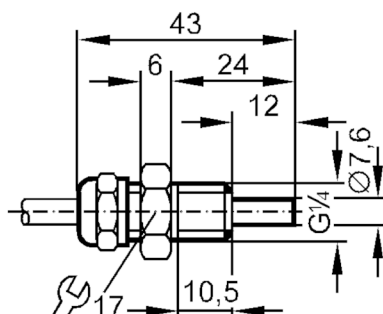

Product characteristics

Process connection G 1/4 external thread

Application

Application high temperature

Media Liquids; Gases

Medium temperature [°C] -25...80

Pressure rating [bar] 30

Liquids

Application high temperature

Medium temperature [°C] -25...80

Gases

Medium temperature [°C] -25...80

Electrical data

Connection to control monitor VS 0100

Measuring/setting range

Liquids

Setting range [cm/s] 3...300

Greatest sensitivity [cm/s] 3...60

Gases

Setting range [cm/s] 5...1500

Accuracy / deviations

Max. temperature gradient of [K/min] medium 15

Reaction times

Response time [s] 1...10

Liquids

Response time [s] 1...10

Gases

Response time [s] 1...10

ST2200



Flow sensor for connection to an evaluation unit

STR14ABB

Operating conditions	
Protection	IP 67
Mechanical data	
Housing	Threaded type
Material	stainless steel (1.4571/316Ti)
Process connection	G 1/4 external thread
Remarks	
Pack quantity	1 pcs.
Electrical connection	
Cable: 2 m, Silflex-PUR; Maximum cable length: 100 m; 4 x 0.5 mm²	
Connection	

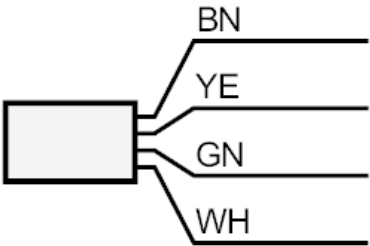

	Core colors :
BK =	black
BN =	brown
BU =	blue
WH =	white