

## Flow monitor

SCR14ADBFPKG/US

Article no longer available - archive entry

Alternative articles: SI0504 + E40099

When selecting an alternative article and accessories please note that technical data may differ!

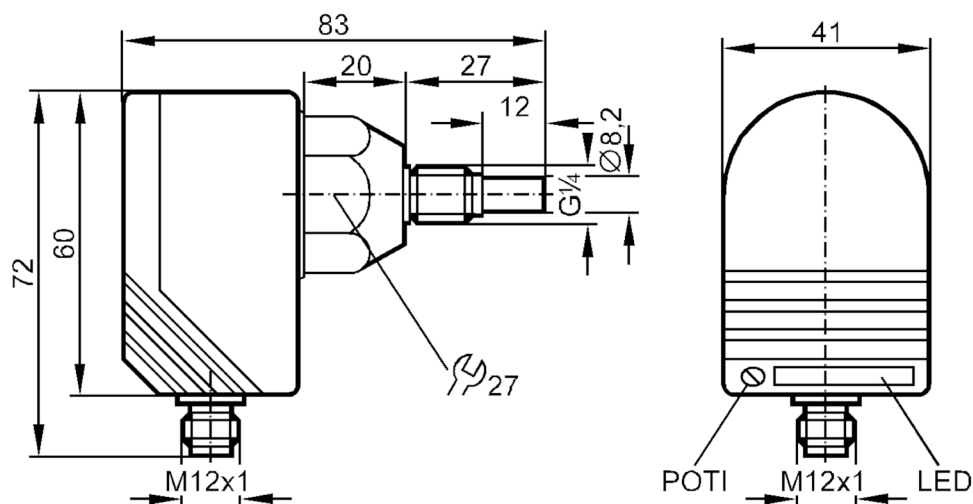

## Product characteristics

Number of inputs and outputs	Number of digital outputs: 1
Process connection	G 1/4 external thread

## Application

Application	high pressure
Media	Liquids
Medium temperature [°C]	-25...80
Pressure rating [bar]	300

## Electrical data

Operating voltage [V]	20...36 DC
Current consumption [mA]	< 45
Reverse polarity protection	yes
Power-on delay time [s]	< 20

## Inputs / outputs

Number of inputs and outputs	Number of digital outputs: 1
------------------------------	------------------------------

## Outputs

Total number of outputs	1
Output signal	switching signal
Electrical design	PNP
Number of digital outputs	1

# ST0545



## Flow monitor

SCR14ADBFPKG/US

Output function	normally open / closed; (configurable)	
Max. voltage drop switching output DC [V]	2.5	
Permanent current rating of switching output DC [mA]	400	
Short-circuit protection	yes	
Type of short-circuit protection	yes (non-latching)	
Overload protection	yes	

### Measuring/setting range

Setting range [cm/s]	3...300
Greatest sensitivity [cm/s]	3...60

### Accuracy / deviations

Max. temperature gradient of medium [K/min]	15
---	----

### Reaction times

Response time [s]	1...10
-------------------	--------

### Software / programming

Adjustment of the switch point	potentiometer
--------------------------------	---------------

### Operating conditions

Ambient temperature [°C]	-20...80
Protection	IP 67

### Mechanical data

Material	PBT-GF20
Materials (wetted parts)	stainless steel (1.4571/316Ti )
Process connection	G 1/4 external thread

### Displays / operating elements

Display	Function	11 x LED
---------	----------	----------

### Remarks

Pack quantity	1 pcs.
---------------	--------

### Electrical connection

Connector: 1 x M12; coding: A



# ST0545



## Flow monitor

SCR14ADBFPKG/US

### Connection

