

SR0125



Control monitor for flow sensors

VS0200 TYP VR31D -25 bis +60G

Article no longer available - archive entry

Alternative articles: SR0126

When selecting an alternative article and accessories please note that technical data may differ!

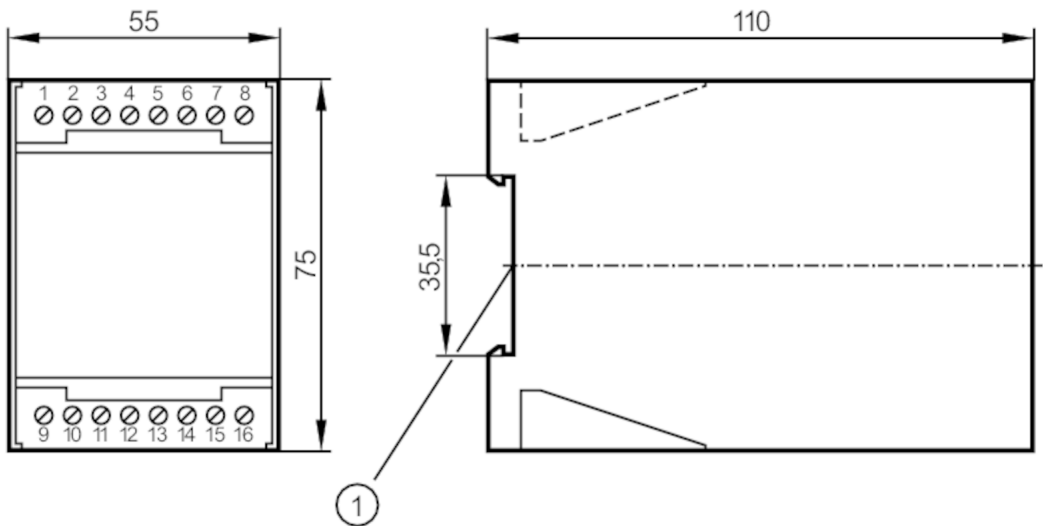

1 Mounting on DIN rail



Application		
Application	Flow monitoring; Wire break monitoring	
Electrical data		
Operating voltage tolerance	[%]	-20...20
Operating voltage	[V]	24 DC
Current consumption	[mA]	70
Power-on delay time	[s]	30
Number of channels		1
Outputs		
Electrical design	Relay	
Contact rating	4 A, 250 V AC	
Switching function flow monitoring	relay energized when flow is present	
Switching function wire break monitoring	relay de-energized in case of wire break	
Reaction times		
Response time	[s]	< 10
Software / programming		
Adjustment of the switch point	potentiometer	
Selection liquids / gases	with slide switch	

SR0125



Control monitor for flow sensors

VS0200 TYP VR31D -25 bis +60G

Operating conditions		
Ambient temperature	[°C]	-25...60
Protection		IP 40
Protection rating terminals		IP 20
Mechanical data		
Housing		housing for DIN rail mounting
Dimensions	[mm]	75 x 55 x 110
Material		plastics
Displays / operating elements		
Display	Function	11 x LED
	Switching status	LED, red
Remarks		
Pack quantity		1 pcs.
Electrical connection		
terminals: 16 x ...2.5 mm²		
Connection		

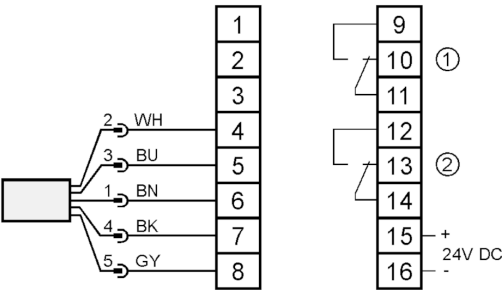

- 1: Relais Wire break monitoring
- 2: Relais Flow monitoring
- Core colors :
- BN = brown
- BU = blue
- BK = black
- WH = white
- GY = grey