

SN0120



Control monitor for flow sensors

VS0200/ 24VDC/230VAC

Article no longer available - archive entry

Alternative articles: SN0150

When selecting an alternative article and accessories please note that technical data may differ!

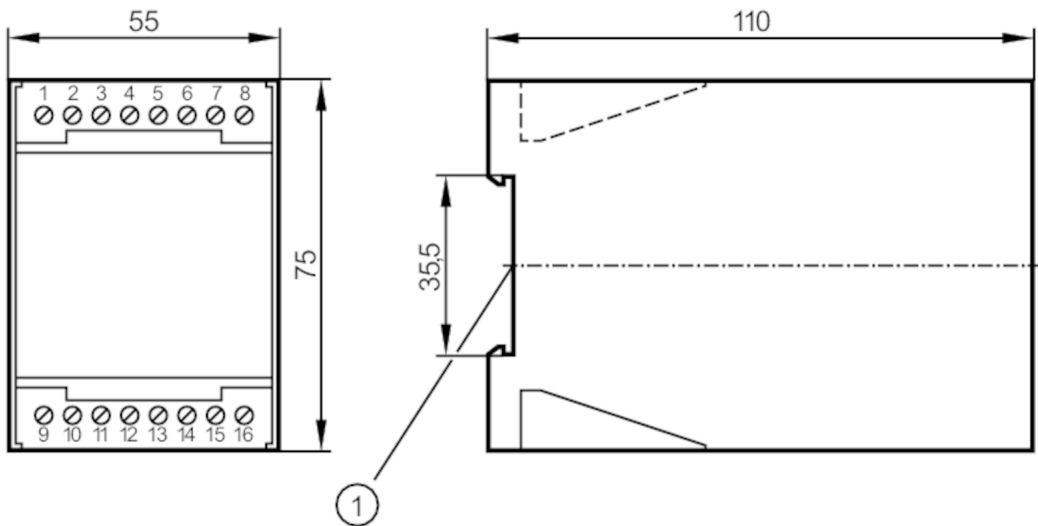

1 Mounting on DIN rail



Application

Application Flow monitoring; switch-off delay at the switch-on moment

Electrical data

Operating voltage tolerance	[%]	-10...10
Operating voltage	[V]	< 230 AC / 24 DC
Current consumption	[mA]	60
Max. power consumption	[VA]	3
Power-on delay time	[s]	0...40
Number of channels		1

Outputs

Electrical design	Relay
Contact rating	4 A, 250 V AC
Switching function flow monitoring	relay energized when flow is present and when timer is on

Software / programming

Adjustment of the switch point	potentiometer
Selection liquids / gases	with slide switch

Operating conditions

Ambient temperature	[°C]	0...60
Protection		IP 40
Protection rating terminals		IP 20

SN0120



Control monitor for flow sensors

VS0200/ 24VDC/230VAC

Mechanical data		
Housing		housing for DIN rail mounting
Dimensions	[mm]	75 x 55 x 110
Material		plastics

Displays / operating elements		
Display	Function	11 x LED

Remarks		
Pack quantity		1 pcs.

Electrical connection

terminals: 16 x ...2.5 mm²

Connection

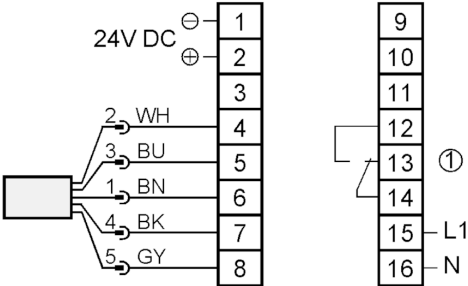

- 1: Relais Flow monitoring
Core colors :
BN = brown
BU = blue
BK = black
WH = white
GY = grey