

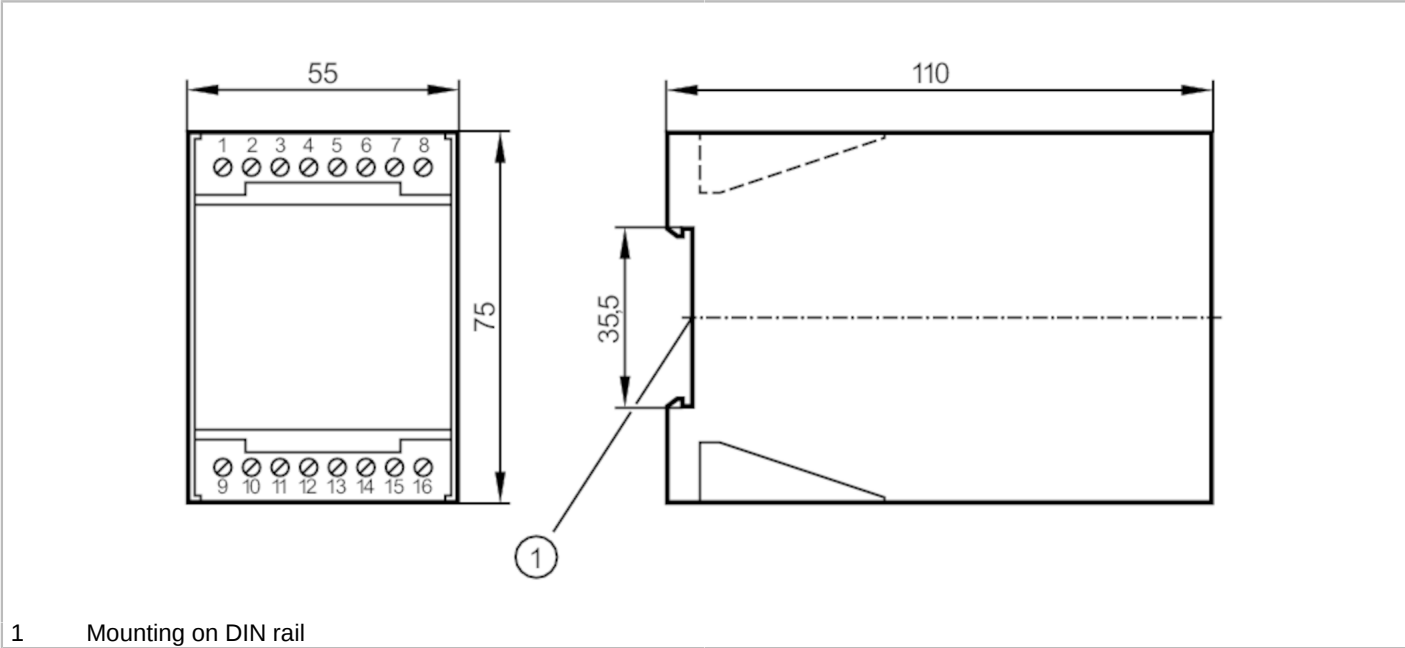

Control monitor for flow sensors

VS0200/230VAC

Article no longer available - archive entry



Application		
Application	Flow monitoring; Temperature monitoring; Wire break monitoring	
Electrical data		
Operating voltage tolerance	[%]	-10...10
Operating voltage	[V]	< 230 AC
Max. power consumption	[VA]	3
Power-on delay time	[s]	< 30
Number of channels		1
Outputs		
Electrical design	Relay	
Contact rating	4 A, 250 V AC	
Switching function flow monitoring	relay energized when flow is present	
Switching function temperature monitoring	relay de-energized when temperature is exceeded	
Switching function wire break monitoring	relay is de-energized in case of wire break and short-circuit	
Reaction times		
Response time	[s]	< 10
Software / programming		
Adjustment of the switch point	potentiometer	
Selection liquids / gases	with slide switch	
Switch point setting	potentiometer	
Temperature range	[°C]	20...100

SN0105



Control monitor for flow sensors

VS0200/230VAC

Repeatability switch point / measured value	[K]	4
---	-----	---

Operating conditions

Ambient temperature	[°C]	-25...70
Protection		IP 40
Protection rating terminals		IP 20

Mechanical data

Housing		housing for DIN rail mounting
Dimensions	[mm]	75 x 55 x 110
Material		plastics

Displays / operating elements

Display	Function	11 x LED
	Switching status	LED, red
	Switching status	LED, red

Remarks

Remarks	If the relay wire/temperature monitoring is de-energized the relay flow monitoring is also de-energized.	
Pack quantity	1 pcs.	

Electrical connection

terminals: 16 x ...2.5 mm²

Connection

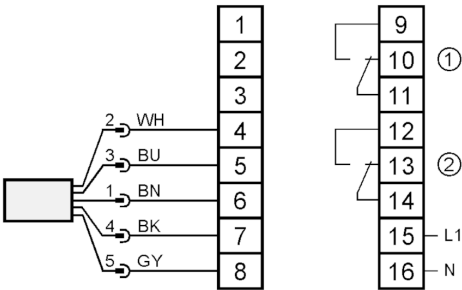

- 1: Relais Wire break monitoring / Temperature monitoring
- 2: Relais Flow monitoring
- Core colors :
- BN = brown
- BU = blue
- BK = black
- WH = white
- GY = grey