

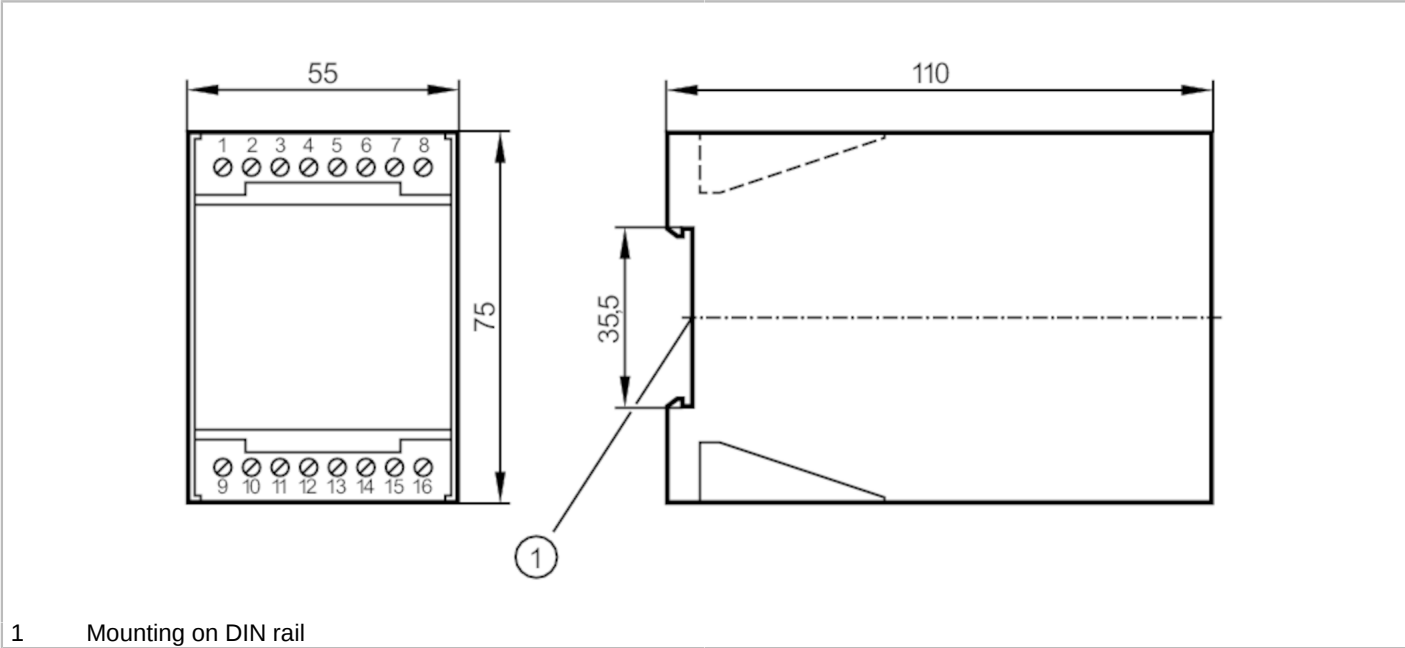

Control monitor for flow sensors

VS0100/110VAC/EX

Article no longer available - archive entry



Application		
Application		Flow monitoring
Electrical data		
Operating voltage tolerance	[%]	-10...10
Operating voltage	[V]	< 110 AC
Max. power consumption	[VA]	2
Power-on delay time	[s]	< 30
Outputs		
Switching function flow monitoring		relay energized when flow is present
Software / programming		
Adjustment of the switch point		potentiometer
Operating conditions		
Ambient temperature	[°C]	0...60
Protection		IP 40
Protection rating terminals		IP 20
Tests / approvals		
Approval		PTB Ex-93.C.2006
Safety classification		
Description		in protection rating intrinsic safety
Voltage	[V]	12,6
Current	[mA]	186
Power	[mW]	586
[Ex ia] IIC designation		[EEx ib] IIC
[Ex ia] IIC inductance		0.5 mH

VS0100/110VAC/EX

Mechanical data

Material	plastics
----------	----------

Displays / operating elements		
Display	Function	LED red

Relay circuit AC	... 250 A V,...6 A COS J > 0,7
Relay circuit DC	80 DC ... 0,3 A I ² /E = 800 mm / 81 DC ... 1 A I ² /E = 800 mm

Remarks

Electrical connection

Connection

1 2

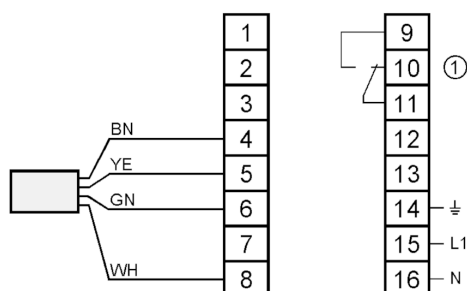

1: Relais Flow monitoring
Core colors :
BN = brown
WH = white
YE = yellow
GN = green