

# SF3305



## Flow sensor for connection to an evaluation unit

SFN12ADB/US-100

Article no longer available - archive entry

Alternative articles: SF5200 + E40107

When selecting an alternative article and accessories please note that technical data may differ!

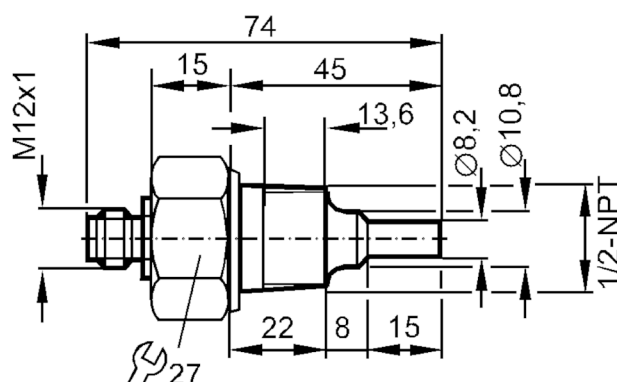

### Product characteristics

Process connection	1/2" NPT
--------------------	----------

### Application

Application	high pressure
Media	Liquids; Gases
Medium temperature [°C]	-25...80
Pressure rating [bar]	300

### Liquids

Application	high pressure
Medium temperature [°C]	-25...80

### Gases

Medium temperature [°C]	-25...80
-------------------------	----------

### Electrical data

Connection to control monitor	VS 0200
-------------------------------	---------

### Measuring/setting range

#### Liquids

Setting range [cm/s]	3...300
Greatest sensitivity [cm/s]	3...60

#### Gases

Setting range [cm/s]	200...2000
Greatest sensitivity [cm/s]	200...800

# SF3305



## Flow sensor for connection to an evaluation unit

SFN12ADB/US-100

Accuracy / deviations	
Max. temperature gradient of [K/min] medium	300
Reaction times	
Response time [s]	1...10
Liquids	
Response time [s]	1...10
Gases	
Response time [s]	1...10
Operating conditions	
Protection	IP 67
Mechanical data	
Housing	Threaded type
Material	stainless steel (1.4571/316Ti )
Materials (wetted parts)	stainless steel (1.4571/316Ti )
Process connection	1/2" NPT
Remarks	
Pack quantity	1 pcs.
Electrical connection	
Connector: 1 x M12; coding: A; Maximum cable length: 100 m	

# SF3305



## Flow sensor for connection to an evaluation unit

SFN12ADB/US-100

### Connection

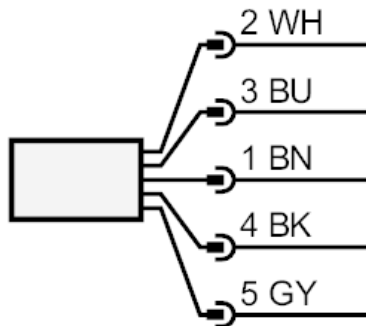

BN =	Core colors :	brown
BU =		blue
BK =		black
WH =		white
GY =		grey