

SF3303



Flow sensor for connection to an evaluation unit

SFR12ZBB/25M

Article no longer available - archive entry

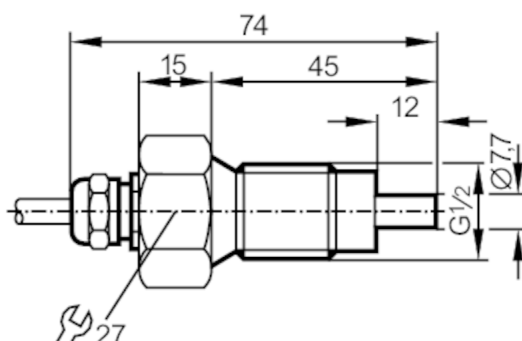

Product characteristics

Process connection	G 1/2 external thread
--------------------	-----------------------

Application

Application	high temperature
Media	Liquids; Gases
Pressure rating [bar]	30

Liquids

Application	high temperature
Medium temperature [°C]	0...120

Gases

Medium temperature [°C]	0...100
-------------------------	---------

Electrical data

Connection to control monitor	VS 0200
-------------------------------	---------

Measuring/setting range

Liquids

Setting range [cm/s]	3...300
Greatest sensitivity [cm/s]	3...60

Gases

Setting range [cm/s]	200...2000
Greatest sensitivity [cm/s]	200...800

Accuracy / deviations

Max. temperature gradient of [K/min] medium	15
---	----

Reaction times

Response time [s]	1...10
-------------------	--------

Liquids

Response time [s]	1...10
-------------------	--------

Gases

Response time [s]	1...10
-------------------	--------

Operating conditions

Protection	IP 67
------------	-------

SF3303



Flow sensor for connection to an evaluation unit

SFR12ZBB/25M

Mechanical data	
Housing	Threaded type
Material	stainless steel (1.4571/316Ti)
Materials (wetted parts)	stainless steel (1.4571/316Ti)
Process connection	G 1/2 external thread
Accessories	
Items supplied	sealings: 2 x AMF 30
Remarks	
Pack quantity	1 pcs.
Electrical connection	
Cable: 25 m; 5 x 0.34 mm ²	
Connection	

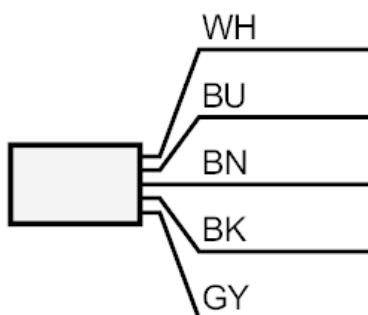

	Core colors :
BN =	brown
BU =	blue
BK =	black
WH =	white
GY =	grey