

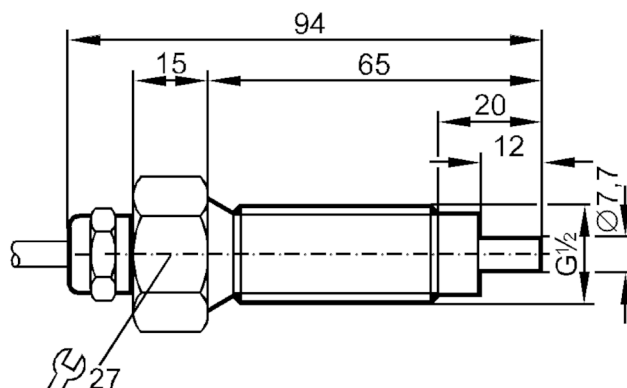

Flow sensor for connection to an evaluation unit

SFR12ABH/10M

Article no longer available - archive entry



Product characteristics

Process connection	G 1/2 external thread
--------------------	-----------------------

Application

Media	Liquids; Gases; aggressive media
-------	----------------------------------

Medium temperature	[°C]	-25...80
--------------------	------	----------

Pressure rating	[bar]	30
-----------------	-------	----

Liquids

Medium temperature	[°C]	-25...80
--------------------	------	----------

Gases

Medium temperature	[°C]	-25...80
--------------------	------	----------

Electrical data

Connection to control monitor	VS 0200
-------------------------------	---------

Measuring/setting range

Liquids

Setting range	[cm/s]	3...300
---------------	--------	---------

Greatest sensitivity	[cm/s]	3...60
----------------------	--------	--------

Gases

Setting range	[cm/s]	200...2000
---------------	--------	------------

Accuracy / deviations

Max. temperature gradient of medium	[K/min]	15
-------------------------------------	---------	----

Reaction times

Response time	[s]	1...10
---------------	-----	--------

SF0531



Flow sensor for connection to an evaluation unit

SFR12ABH/10M

Liquids		
Response time	[s]	1...10
Gases		
Response time	[s]	1...10
Operating conditions		
Protection		IP 67
Mechanical data		
Housing		Threaded type
Material		Hastelloy C-4 (2.4610)
Materials (wetted parts)		Hastelloy C-4 (2.4610)
Process connection		G 1/2 external thread
Accessories		
Items supplied		sealings: 2 x AMF 30
Remarks		
Pack quantity		1 pcs.
Electrical connection		
Cable: 10 m, PUR; Maximum cable length: 100 m; 5 x 0.34 mm ²		
Connection		

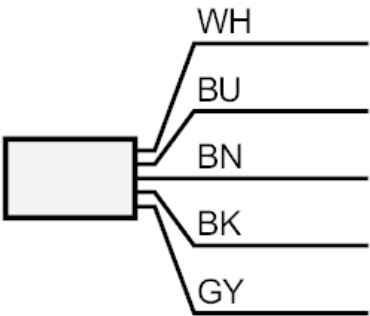

	Core colors :
BN =	brown
BU =	blue
BK =	black
WH =	white
GY =	grey