

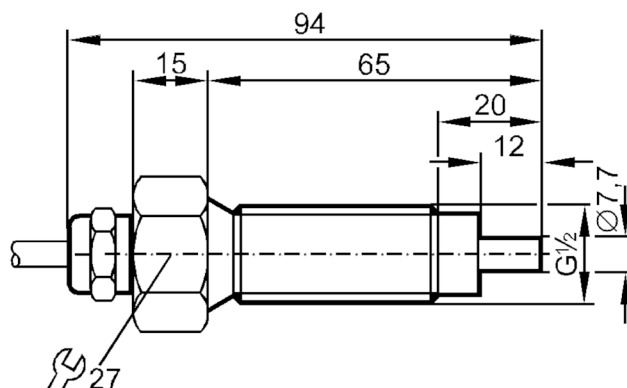

## Flow sensor for connection to an evaluation unit

SFR12ABH

Article no longer available - archive entry



## Product characteristics

Process connection	G 1/2 external thread
--------------------	-----------------------

## Application

Application	high temperature
Media	Liquids; Gases
Medium temperature [°C]	-25...80
Pressure rating [bar]	30

## Liquids

Application	high temperature
Medium temperature [°C]	-25...80

## Gases

Medium temperature [°C]	-25...80
-------------------------	----------

## Electrical data

Connection to control monitor	VS 0200
-------------------------------	---------

## Measuring/setting range

## Liquids

Setting range [cm/s]	3...300
Greatest sensitivity [cm/s]	3...60

## Gases

Setting range [cm/s]	100...2000
Greatest sensitivity [cm/s]	100...800

## Accuracy / deviations

Max. temperature gradient of [K/min] medium	15
---	----

# SF0526



## Flow sensor for connection to an evaluation unit

SFR12ABH

Reaction times		
Response time	[s]	2...10
Liquids		
Response time	[s]	2...10
Gases		
Response time	[s]	2...10
Operating conditions		
Protection		IP 67
Mechanical data		
Housing		Threaded type
Material		Hastelloy C-22 (2.4602)
Materials (wetted parts)		Hastelloy C-22 (2.4602)
Process connection		G 1/2 external thread
Accessories		
Items supplied		sealings: 2 x AMF 30
Remarks		
Pack quantity		1 pcs.
Electrical connection		
Cable: 2 m, PUR; Maximum cable length: 100 m; 5 x 0.34 mm <sup>2</sup>		
Connection		

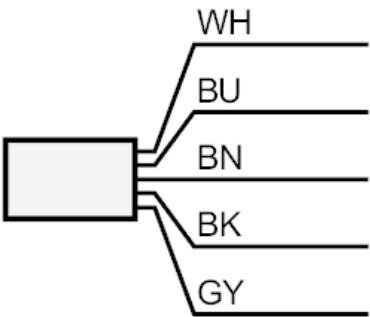

	Core colors :
BK =	black
BN =	brown
BU =	blue
WH =	white
GY =	grey