

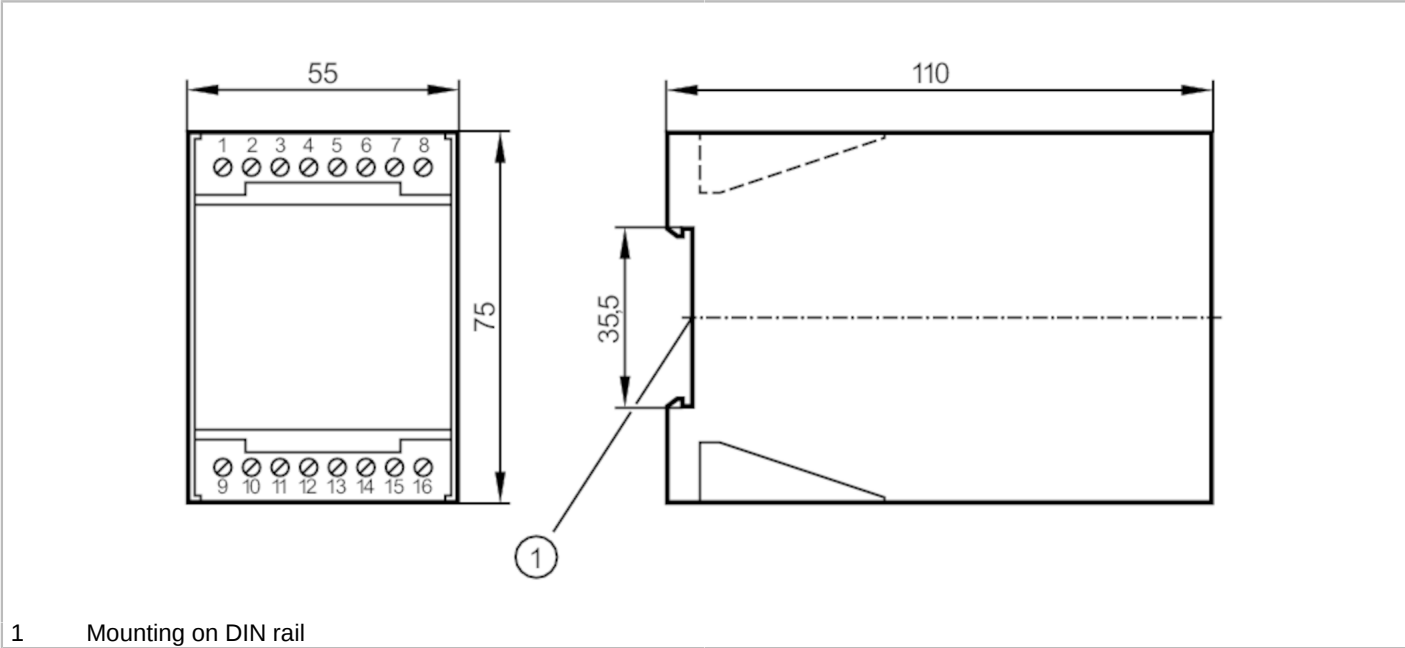

Control monitor for flow sensors

VS0200/ 30- 60VDC/30- 42VAC

Article no longer available - archive entry



Application		
Application		Flow monitoring
Electrical data		
Operating voltage	[V]	30...42 AC / 30...60 DC
Power-on delay time	[s]	30
Number of channels		1
Outputs		
Electrical design		Relay
Contact rating		4 A, 250 V AC
Switching function flow monitoring		relay energized when flow is present
Software / programming		
Adjustment of the switch point		potentiometer
Selection liquids / gases		with slide switch
Operating conditions		
Ambient temperature	[°C]	0...60
Protection		IP 40
Protection rating terminals		IP 20
Mechanical data		
Housing		housing for DIN rail mounting
Dimensions	[mm]	75 x 55 x 110
Material		plastics

SB0100



Control monitor for flow sensors

VS0200/ 30- 60VDC/30- 42VAC

Displays / operating elements

Display	Function	11 x LED
---------	----------	----------

Remarks

Pack quantity	1 pcs.
---------------	--------

Electrical connection

terminals: 16 x ...2.5 mm²

Connection

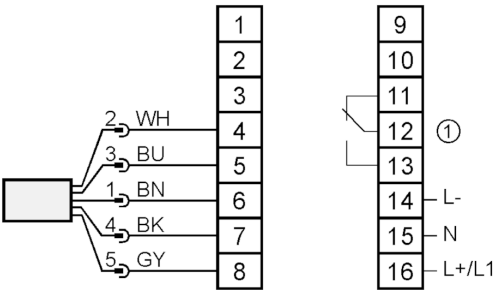

- 1: Relais Flow monitoring  
Core colors :  
BN = brown  
BU = blue  
BK = black  
WH = white  
GY = grey