

# RV6134



## Incremental encoder with solid shaft

RV-1080-I24/L6

Article no longer available - archive entry

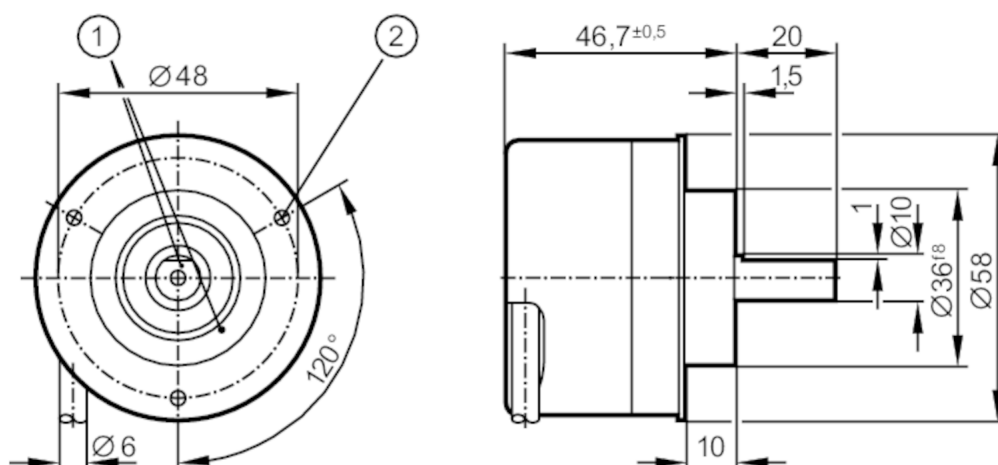

- 1 reference mark
- 2 M3 Depth 5 mm



### Product characteristics

Resolution	1080 resolution
Shaft design	solid shaft
Shaft diameter [mm]	10

### Electrical data

Operating voltage [V]	10...30 DC
Current consumption [mA]	< 150

### Outputs

Electrical design	HTL
Max. current load per output [mA]	50
Switching frequency [kHz]	300
Type of short-circuit protection	< 60 s
Phase difference A und B [°]	90

### Measuring/setting range

Resolution	1080 resolution
------------	-----------------

### Operating conditions

Ambient temperature [°C]	-40...100
Note on ambient temperature	firmly laid cable: -40 °C
Max. relative air humidity [%]	98
Protection	IP 64; (on the housing: IP 67; on the shaft: IP 64)

### Tests / approvals

Shock resistance	200 g
Vibration resistance	30 g

# RV6134



## Incremental encoder with solid shaft

RV-1080-I24/L6

Mechanical data		
Dimensions	[mm]	Ø 58 / L = 46.7
Material		aluminum
Max. revolution, mechanical	[U/min]	12000
Max. starting torque	[Nm]	1
Reference temperature torque	[°C]	20
Shaft design		solid shaft
Shaft diameter	[mm]	10
Shaft material		steel (1.4104)
Max. shaft load axial (at the shaft end)	[N]	10
Max. shaft load radial (at the shaft end)	[N]	20

Electrical connection	
Cable: 6 m, PUR; Maximum cable length: 300 m; radial, can also be used axially	
brown	A
green	A inverted
grey	B
pink	B inverted
red	0 index
black	0 index inverted
blue	L+ sensor
white	0V sensor
brown/green	L+ (Up)
white/green	0V (Un)
lilac	error inverted
screen	housing

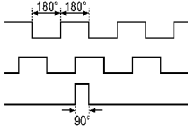
Diagrams and graphs	
Pulse diagram	<div><p>Direction of rotation clockwise (looking at the shaft)</p></div>