

# RC6042



## Incremental encoder with solid shaft

RC-0512-I24/N2

Article no longer available - archive entry

Alternative articles: RC6015  
When selecting an alternative article and accessories please note that technical data may differ!

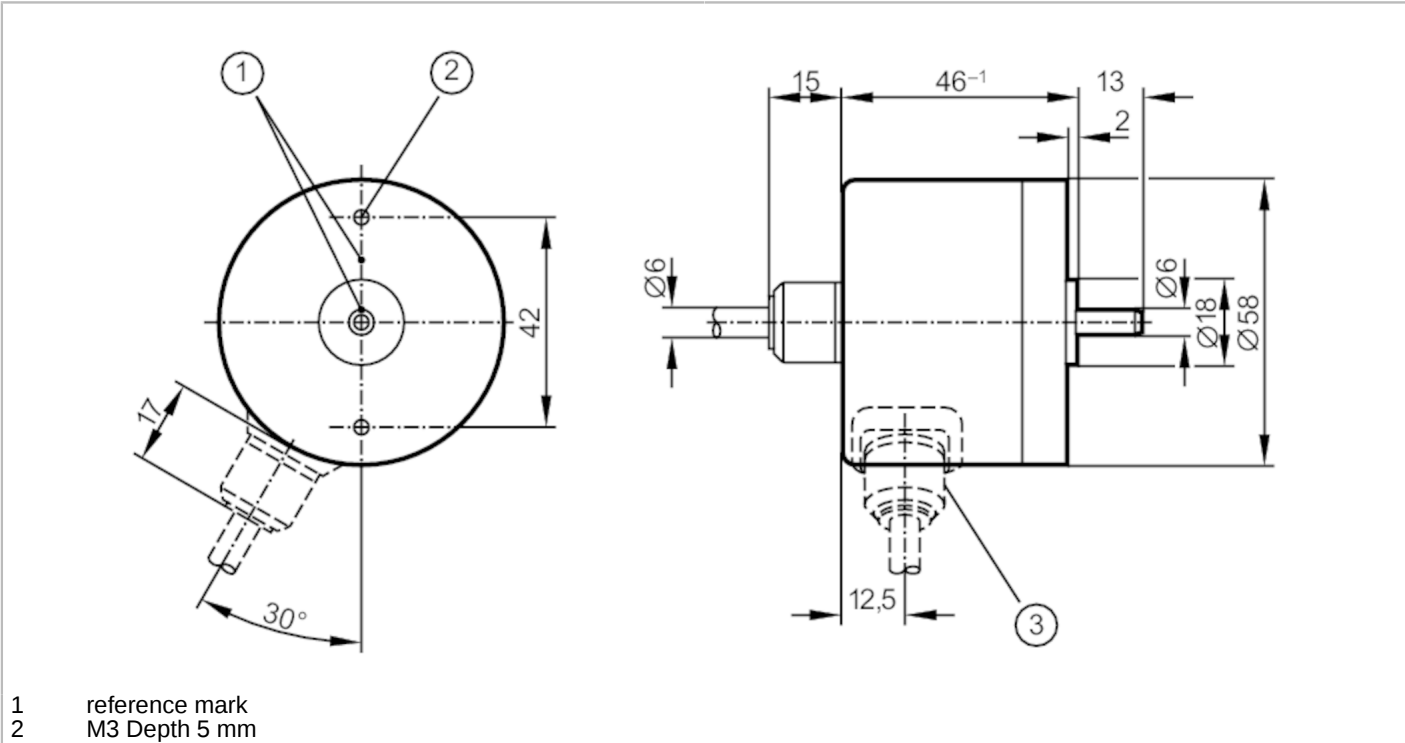

Product characteristics		
Resolution		512 resolution
Shaft design		solid shaft
Shaft diameter	[mm]	6
Electrical data		
Operating voltage	[V]	10...30 DC
Current consumption	[mA]	150
Outputs		
Electrical design		HTL
Max. current load per output	[mA]	50
Switching frequency	[kHz]	300
Type of short-circuit protection		< 60 s
Phase difference A und B	[°]	90
Measuring/setting range		
Resolution		512 resolution
Operating conditions		
Ambient temperature	[°C]	-20...85
Storage temperature	[°C]	-30...100

# RC6042



## Incremental encoder with solid shaft

RC-0512-I24/N2

Max. relative air humidity	[%]	98
Protection		IP 64

### Tests / approvals

Shock resistance		100 g (6 ms)
Vibration resistance		10 g (55...2000 Hz)

### Mechanical data

Dimensions	[mm]	Ø 58 / L = 46
Material		aluminum
Max. revolution, mechanical [U/min]		12000
Max. starting torque	[Nm]	1
Reference temperature torque	[°C]	20
Shaft design		solid shaft
Shaft diameter	[mm]	6
Shaft material		steel (1.4104)
Max. shaft load axial (at the shaft end)	[N]	10
Max. shaft load radial (at the shaft end)	[N]	20

### Electrical connection

Cable: 2 m, PUR; radial

brown	A
green	A inverted
grey	B
pink	B inverted
red	0 index
black	0 index inverted
blue	L+ sensor
white	0V sensor
brown/green	L+ (Up)
white/green	0V (Un)
lilac	error inverted
screen	housing

### Diagrams and graphs

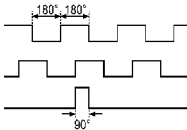
Pulse diagram	 <p>Direction of rotation clockwise (looking at the shaft)</p>
---------------	--