



## Incremental encoder with solid shaft

RB-0100-I24/L4

Article no longer available - archive entry

Alternative articles: RB3500

When selecting an alternative article and accessories please note that technical data may differ!

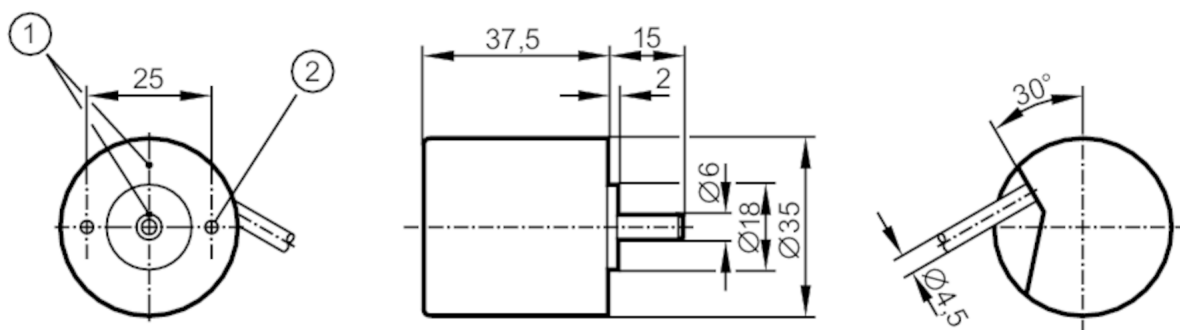

- 1 reference mark  
2 M3 Depth 5 mm



## Product characteristics

Resolution	100 resolution
Shaft design	solid shaft
Shaft diameter [mm]	6

## Application

Function principle	incremental
--------------------	-------------

## Electrical data

Operating voltage [V]	10...30 DC
Current consumption [mA]	150

## Outputs

Electrical design	HTL
Max. current load per output [mA]	50
Switching frequency [kHz]	160
Type of short-circuit protection	< 60 s
Phase difference A und B [°]	90

## Measuring/setting range

Resolution	100 resolution
------------	----------------

## Operating conditions

Ambient temperature [°C]	-30...70
Max. relative air humidity [%]	75; (briefly: 95 %)
Protection	IP 64

## Tests / approvals

Shock resistance	100 g (6 ms)
------------------	--------------



Incremental encoder with solid shaft

RB-0100-I24/L4

Vibration resistance	10 g (55...2000 Hz)
----------------------	---------------------

Mechanical data

Weight	[g]	553.6
Dimensions	[mm]	Ø 35 / L = 52.5
Material		aluminum
Max. revolution, mechanical	[U/min]	10000
Max. starting torque	[Nm]	1
Reference temperature torque	[°C]	20
Shaft design		solid shaft
Shaft diameter	[mm]	6
Shaft material		steel (1.4104)
Max. shaft load axial (at the shaft end)	[N]	5
Max. shaft load radial (at the shaft end)	[N]	10

Electrical connection

Cable: 4 m, PUR; radial, can also be used axially

brown	A
green	A V A
grey	B
pink	0 V B
red	0 index
black	0 V 0 index
brown/green	L+ (Up)
white/green	L- 0 V (Un)
lilac	error inverted
screen	housing

Diagrams and graphs

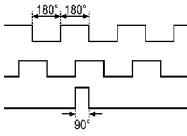
Pulse diagram	 <p>Direction of rotation clockwise (looking at the shaft)</p>
---------------	--