

PN7222



Pressure sensor with display

PN-100PSBN14-QFP

Article no longer available - archive entry

Alternative articles: PN7202
When selecting an alternative article and accessories please note that technical data may differ!

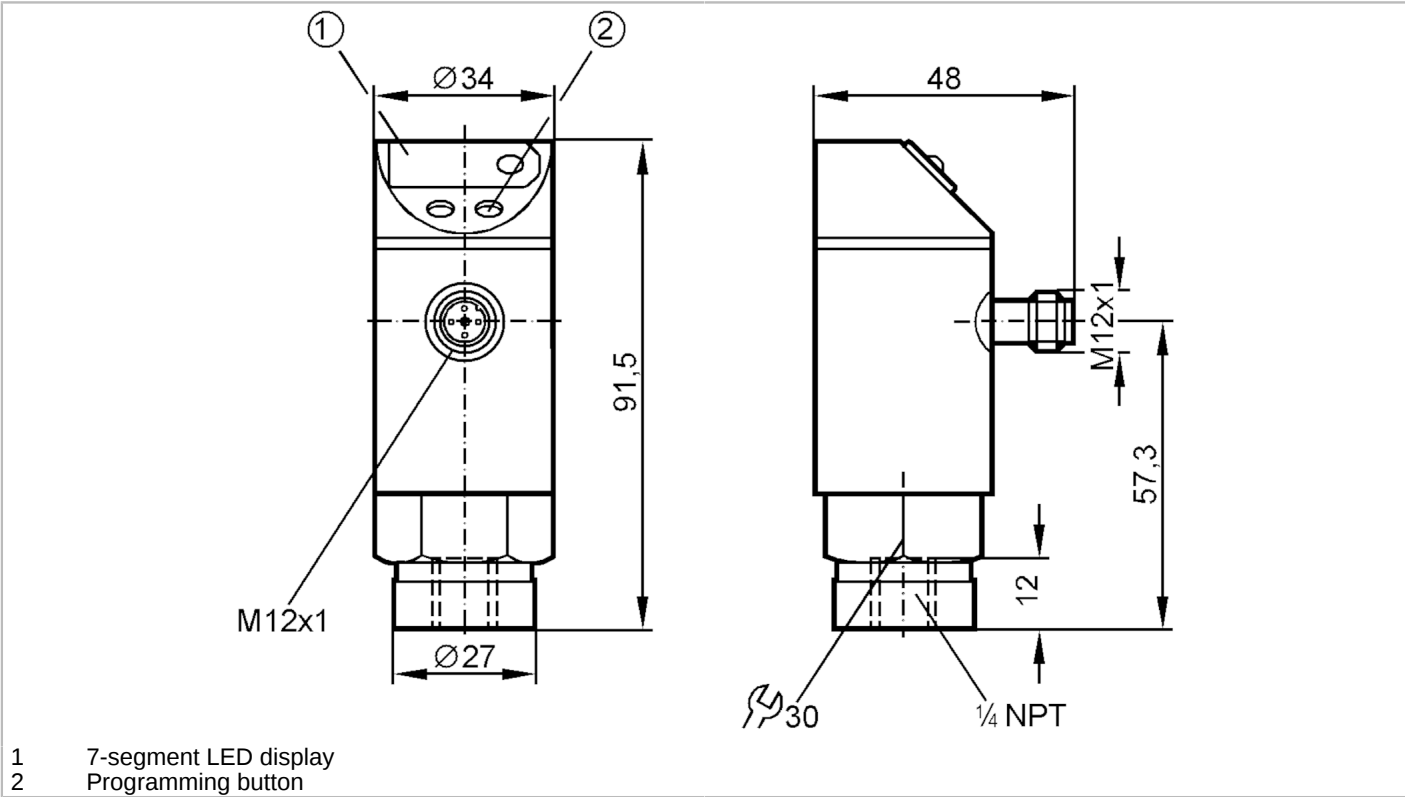

Product characteristics		
Number of inputs and outputs		Number of digital outputs: 2
Measuring range	[psi]	0...1000
Process connection		threaded connection 1/4" NPT external thread
Application		
System		gold-plated contacts
Application		for industrial applications
Media		liquids and gases
Conditionally suitable for		For gaseous media the application is limited to max. 25 bar.
Medium temperature	[°C]	-25...80
Min. bursting pressure	[psi]	9000
Pressure rating	[psi]	4500
Type of pressure		relative pressure
Electrical data		
Operating voltage	[V]	18...30 DC
Current consumption	[mA]	< 60
Min. insulation resistance	[MΩ]	100; (500 V DC)
Protection class		III



Pressure sensor with display

PN-100PSBN14-QFP

Reverse polarity protection	yes
Power-on delay time [s]	0.2
Integrated watchdog	yes

Inputs / outputs

Number of inputs and outputs	Number of digital outputs: 2
------------------------------	------------------------------

Outputs

Total number of outputs	2
Output signal	switching signal
Electrical design	PNP
Number of digital outputs	2
Output function	normally open / closed; (configurable)
Max. voltage drop switching output DC [V]	2
Permanent current rating of switching output DC [mA]	250
Short-circuit protection	yes
Type of short-circuit protection	yes (non-latching)
Overload protection	yes

Measuring/setting range

Measuring range [psi]	0...1000
Set point SP [psi]	10...999
Reset point rP [psi]	5...995
In steps of [psi]	5

Accuracy / deviations

Switch point accuracy [% of the final value]	$< \pm 1,0$
Repeatability [% of the final value]	$< \pm 0,25$; (with temperature fluctuations < 10 K)
Temperature drift per 10 K	$< \pm 0.3$

Reaction times

Switching frequency for a given set response time of one output	Response time (dAP) [ms]	3	6	10	17	30	60	125	250	500
	Switching frequency [Hz]	170	80	50	30	16	8	4	2	1
Response time [ms]	at rectangular pressure characteristic; Set point (SPx) = 70 %; Reset point (rPx) = 30 %									
Delay time programmable dS, dr [s]	0, 0,2,...10, 11,...50									

Software / programming

Adjustment of the switch point	Programming button
Parameter setting options	hysteresis / window; normally open / closed; switch-on/switch-off delay; Damping

Operating conditions

Ambient temperature [°C]	-25...80
Storage temperature [°C]	-40...100

PN7222



Pressure sensor with display

PN-100PSBN14-QFP

Protection	IP 67
------------	-------

Tests / approvals

EMC	EN 61000-4-2 ESD	4 kV CD / 8 kV AD
	EN 61000-4-3 HF radiated	10 V/m
	EN 61000-4-4 Burst	2 kV
	EN 61000-4-6 HF conducted	10 V
Shock resistance	DIN IEC 68-2-27	50 g (11 ms)
Vibration resistance	DIN IEC 68-2-6	20 g (10...2000 Hz)

Mechanical data

Material	EPDM/X; FKM; PA; PBT; PC; PTFE; stainless steel (1.4301 / 304)
Materials (wetted parts)	stainless steel (1.4305 / 303); ceramics; FKM
Min. pressure cycles	100 million
Process connection	threaded connection 1/4" NPT external thread

Displays / operating elements

Display	Switching status	2 x LED, red
	Function display	7-segment LED display
	Measured values	7-segment LED display

Remarks

Pack quantity	1 pcs.
---------------	--------

Electrical connection

Connector: 1 x M12; coding: A; Contacts: gold-plated



Connection

