

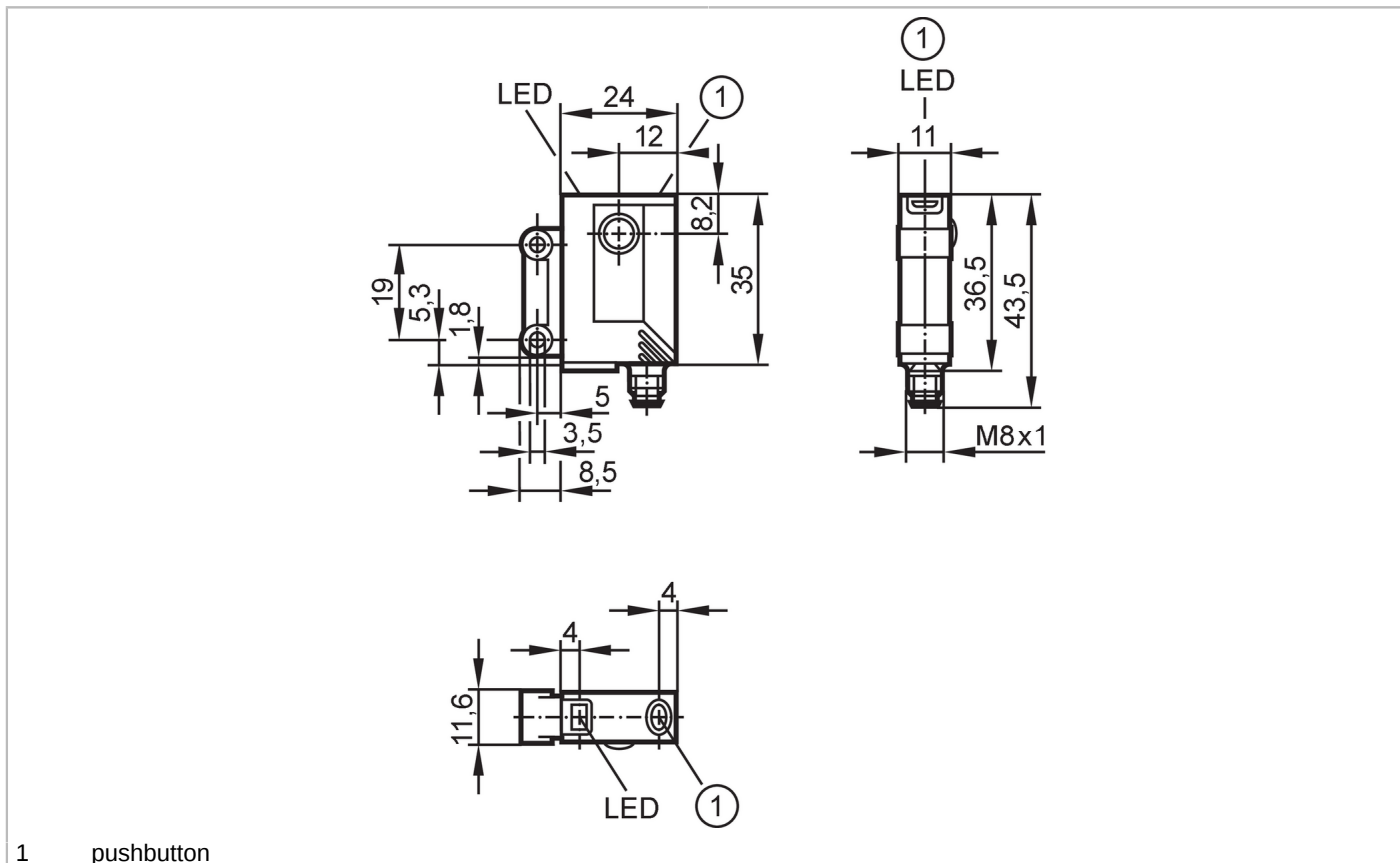

## Retro-reflective LASER sensor

OJPLFPKG/FO/AS



1 pushbutton



| Product characteristics               |      |                                       |
|---------------------------------------|------|---------------------------------------|
| Type of light                         |      | red light                             |
| Laser protection class                |      | 1                                     |
| Housing                               |      | rectangular                           |
| Application                           |      |                                       |
| Special feature                       |      | polarization filter                   |
| Function principle                    |      | Retro-reflective sensor               |
| Electrical data                       |      |                                       |
| Operating voltage                     | [V]  | 10...30 DC                            |
| Current consumption                   | [mA] | < 15                                  |
| Protection class                      |      | III                                   |
| Reverse polarity protection           |      | yes                                   |
| Type of light                         |      | red light                             |
| Wave length                           | [nm] | 650                                   |
| Typ. lifetime                         | [h]  | 50000                                 |
| Outputs                               |      |                                       |
| Electrical design                     |      | PNP                                   |
| Output function                       |      | light-on/dark-on mode; (programmable) |
| Max. voltage drop switching output DC | [V]  | 2.5                                   |

# OJ5114



## Retro-reflective LASER sensor

OJPLFPKG/FO/AS

|  |                    |
|--|--------------------|
| Permanent current rating of switching output DC [mA] | 200                |
| Switching frequency DC [Hz]                          | 2000               |
| Short-circuit protection                             | yes                |
| Type of short-circuit protection                     | yes (non-latching) |
| Overload protection                                  | yes                |

| Monitoring range                                |  |
|---|--|
| Range referred to prismatic reflector [m]       | 8; (Prismatic reflector 50 x 50 mm E20722) |
| Range adjustable                                | yes  |
| Diameter of the smallest detectable object [mm] | 2.5; (0,1 m; 2,5 m: 4; 5 m: 8)             |
| Max. light spot diameter [mm]                   | 12   |
| Light spot dimensions refer to                  | at maximum range                           |
| Polarization filter available                   | yes  |

| Operating conditions     |          |
|--------------------------|----------|
| Ambient temperature [°C] | -10...60 |
| Protection               | IP 67    |

| Tests / approvals         |                          |   |
|---------------------------|--------------------------|---|
| EMC                       | EN 60947-5-2             |   |
| Laser protection class    | 1                        |   |
| Notes on laser protection | Caution:<br>laser class: | Laser light<br>1  |
|                           |                          | EN / IEC60825-1:2007  |
|                           |                          | EN / IEC60825-1:2014  |
|                           |                          | Complies with 21 CFR 1040.10 except for conformance with IEC 60825-1 Ed. 3, as described in Laser Notice No. 56, dated May 8, 2019. |
| MTTF [years]              | 706                      |   |

| Mechanical data |  |
|-----------------|--|
| Weight [g]      | 27.9   |
| Housing         | rectangular                                      |
| Dimensions [mm] | 35 x 24 x 11                                     |
| Material        | housing: ABS; LED window: SEPS; pushbutton: SEPS |
| Lens material   | front lens:glass                                 |
| Lens alignment  | Front sensing                                    |

| Displays / operating elements |                  |                 |
|-------------------------------|------------------|-----------------|
| Display                       | Switching status | 1 x LED, yellow |
|                               | Power            | 1 x LED, green  |
|                               | Function         | 1 x LED, red    |
| Electronic lock               | yes              |                 |

| Accessories    |                   |
|----------------|-------------------|
| Items supplied | screws: 2         |
|                | spring washers: 2 |
|                | Nuts: 2           |

# OJ5114



## Retro-reflective LASER sensor

OJPLFPKG/FO/AS

### Remarks

|               |                                 |
|---------------|---------------------------------|
| Remarks       | cULus - Class 2 source required |
| Pack quantity | 1 pcs.                          |

### Electrical connection

Connector: 1 x M8; coding: A



### Connection

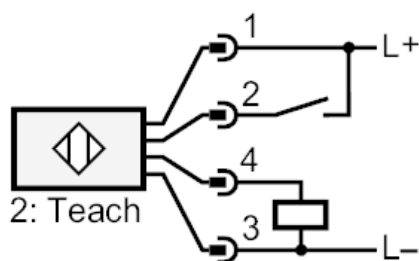

2 Teach

### Diagrams and graphs

excess gain graph

