

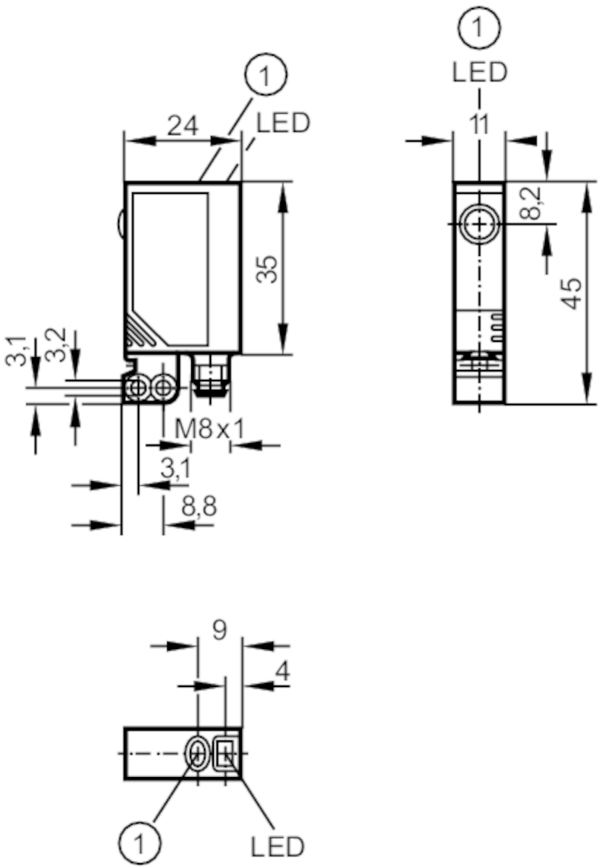

Through-beam laser sensor receiver

OJELFPKG/SO/AS



1 pushbutton



Product characteristics		
Type of light		red light
Laser protection class		1
Housing		rectangular
Application		
Function principle		Through-beam sensor
Electrical data		
Operating voltage	[V]	10...30 DC
Current consumption	[mA]	< 12
Protection class		III
Reverse polarity protection		yes
Type of light		red light
Wave length	[nm]	650
Typ. lifetime	[h]	50000
Outputs		
Electrical design		PNP



Through-beam laser sensor receiver

OJELFPKG/SO/AS

Output function	light-on/dark-on mode; (programmable)	
Max. voltage drop switching output DC [V]	2.5	
Permanent current rating of switching output DC [mA]	200	
Switching frequency DC [Hz]	1200	
Short-circuit protection	yes	
Type of short-circuit protection	yes (non-latching)	
Overload protection	yes	

Monitoring range		
Transmitter / receiver	receiver	
Range [m]	< 15	
Range adjustable	yes	
Diameter of the smallest detectable object [mm]	2	

Operating conditions		
Ambient temperature [°C]	-10...60	
Protection	IP 67	

Tests / approvals		
EMC	EN 60947-5-2	
Laser protection class	1	
Notes on laser protection	Caution:	Laser light
	laser class:	1
		EN / IEC60825-1:2007
		EN / IEC60825-1:2014
		Complies with 21 CFR 1040 except for deviations pursuant to Laser Notice No. 50, dated June 2007.
MTTF [years]	952	

Mechanical data		
Weight [g]	26.85	
Housing	rectangular	
Dimensions [mm]	35 x 11 x 24	
Material	housing: ABS; fixture: diecast zinc; LED window: SEPS; pushbutton: SEPS	
Lens material	glass	
Lens alignment	Side sensing	

Displays / operating elements		
Display	Switching status	1 x LED, yellow
	Power	1 x LED, green
	Function	1 x LED, red
Electronic lock	yes	

Accessories		
Items supplied	Basic clip: 1, E20964	
	screws: 2 x M3 x 16	
	spring washers: 2	
	Nuts: 2	



Through-beam laser sensor receiver

OJELFPKG/SO/AS

Remarks	
Remarks	cULus - Class 2 source required
Pack quantity	1 pcs.

Electrical connection

Connector: 1 x M8; coding: A

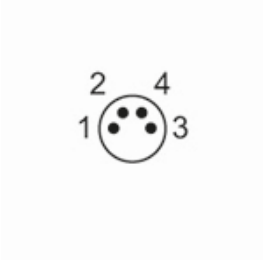

Connection

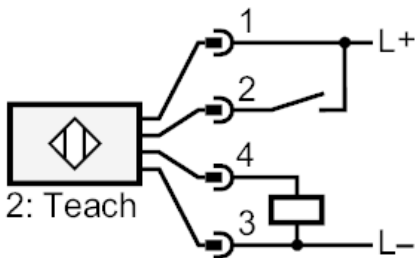

2 Teach



Through-beam laser sensor receiver

OJELFPKG/SO/AS

Diagrams and graphs

excess gain graph

