

## Through-beam sensor transmitter

OGS-00KG/US/V4A/CUBE

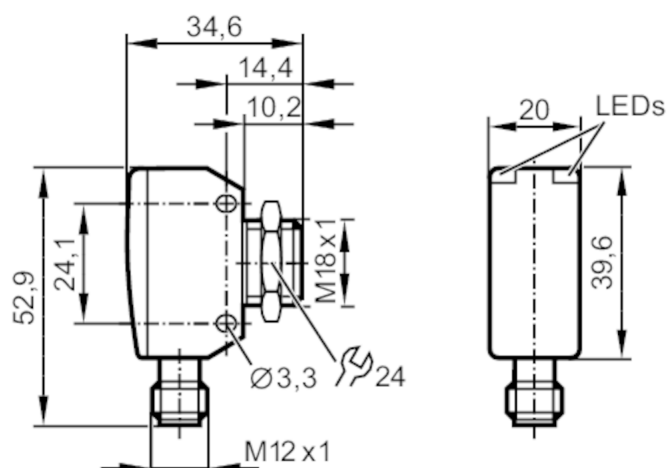

## Product characteristics

Type of light	red light
Housing	rectangular with M18 thread

## Application

Function principle	Through-beam sensor
--------------------	---------------------

## Electrical data

Operating voltage	[V]	10...30 DC
Rated insulation voltage	[V]	32
Current consumption	[mA]	17
Protection class		III
Reverse polarity protection		yes
Max. power-on delay time	[ms]	300
Type of light		red light
Wave length	[nm]	662

## Monitoring range

Transmitter / receiver		transmitter
Range	[m]	15
Max. light spot diameter	[mm]	800
Light spot dimensions refer to		at maximum range

## Interfaces

Communication interface		IO-Link
Transmission type		COM2 (38,4 kBaud)
IO-Link revision		1.1
SDCI standard		IEC 61131-9
Profiles		Smart Sensor: Device Identification, Device Diagnosis
SIO mode		no
Required master port class		A
Min. process cycle time	[ms]	2.5



## Through-beam sensor transmitter

OGS-00KG/US/V4A/CUBE

IO-Link process data (cyclical)	<b>Function</b>	<b>bit length</b>
IO-Link functions (acyclical)	device status	4
Supported DeviceIDs	application specific tag; operating hours counter	
Note	<b>Type of operation</b>	<b>DeviceID</b>
	default	1135
For further information please see the IODD PDF file at "Downloads"		

Operating conditions		
Ambient temperature	[°C]	-25...80
Storage temperature	[°C]	-40...80
Protection	IP 65; IP 67; IP 68; IP 69K	

Tests / approvals		
EMC	EN 60947-5-2	
MTTF	[years]	1011
UL approval	Ta	-25...80 °C
	Enclosure type	Type 1
	voltage supply	Class 2
	File number UL	E174191

Mechanical data		
Weight	[g]	78
Housing	rectangular with M18 thread	
Dimensions	[mm]	52.9 x 20 x 34.6
Thread designation	M18 x 1	
Material	stainless steel (630/1.4542/17-4 PH); PEI	
Lens material	PEI	
Lens alignment	Side sensing	

Displays / operating elements		
Display	Power	1 x LED, green

Accessories		
Items supplied	lock nut: 1	

Remarks		
Remarks	cULus - Class 2 source required	
Pack quantity	1 pcs.	

Electrical connection		
-----------------------	--	--

Connector: 1 x M12; coding: A



## Through-beam sensor transmitter

OGS-00KG/US/V4A/CUBE

### Connection

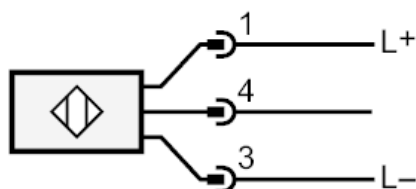

### Diagrams and graphs

excess gain graph

