

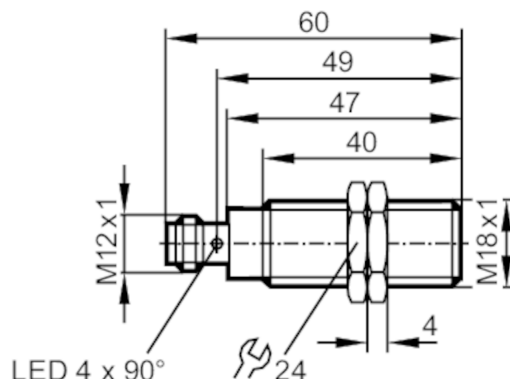

## Through-beam sensor transmitter

OGS-00KG/US100



## Product characteristics

Type of light	red light
Housing	Threaded type

## Application

Function principle	Through-beam sensor
--------------------	---------------------

## Electrical data

Operating voltage [V]	10...36 DC
Current consumption [mA]	15
Protection class	II
Reverse polarity protection	yes
Type of light	red light
Wave length [nm]	624

## Monitoring range

Transmitter / receiver	transmitter
Range [m]	< 20
Range adjustable	no
Max. light spot diameter [mm]	800
Light spot dimensions refer to	at maximum range

## Operating conditions

Ambient temperature [°C]	-25...80
Protection	IP 65; IP 67; IP 68; IP 69K

## Tests / approvals

EMC	EN 60947-5-2
MTTF [years]	755

## Mechanical data

Weight [g]	59.4
Housing	Threaded type
Dimensions [mm]	M18 x 1 / L = 60
Thread designation	M18 x 1

# OGS300



## Through-beam sensor transmitter

OGS-00KG/US100

Material	housing: stainless steel (1.4404 / 316L); sealing: EPDM
Lens material	PMMA

### Displays / operating elements

Display	Power	1 x LED, green
---------	-------	----------------

### Accessories

Items supplied	lock nuts: 2
----------------	--------------

### Remarks

Remarks	cULus - Class 2 source required
Pack quantity	1 pcs.

### Electrical connection

Connector: 1 x M12; coding: A



### Connection

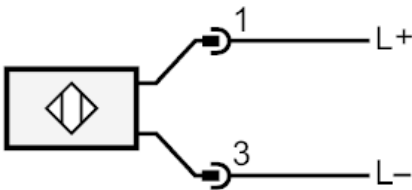



## Through-beam sensor transmitter

OGS-00KG/US100

### Diagrams and graphs

excess gain graph

