

# OGE300

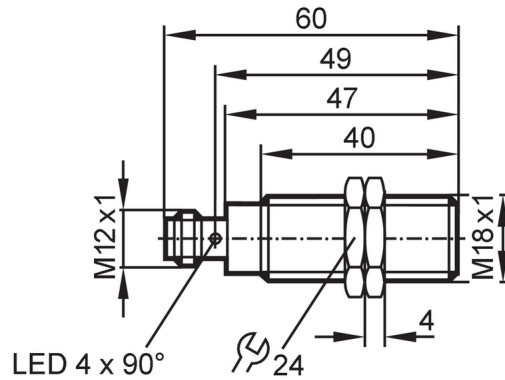

## Through-beam sensor receiver

OGE-DPKG/US100



Product characteristics	
Type of light	red light
Housing	Threaded type
Application	
Function principle	Through-beam sensor
Application	food and beverage industry
Electrical data	
Operating voltage [V]	10...36 DC
Current consumption [mA]	10
Protection class	II
Reverse polarity protection	yes
Type of light	red light
Wave length [nm]	624
Outputs	
Electrical design	PNP
Output function	dark-on mode
Max. voltage drop switching output DC [V]	2.5
Permanent current rating of switching output DC [mA]	150; (200 (...60 °C))
Switching frequency DC [Hz]	1000
Short-circuit protection	yes
Type of short-circuit protection	yes (non-latching)
Overload protection	yes
Monitoring range	
Transmitter / receiver	receiver
Range [m]	< 20
Range adjustable	no
Operating conditions	
Ambient temperature [°C]	-25...80
Protection	IP 65; IP 67; IP 68; IP 69K

# OGE300



## Through-beam sensor receiver

OGE-DPKG/US100

### Tests / approvals

EMC	EN 60947-5-2	
MTTF [years]		1112

### Mechanical data

Weight [g]	59.8
Housing	Threaded type
Dimensions [mm]	M18 x 1 / L = 60
Thread designation	M18 x 1
Material	housing: stainless steel (1.4404 / 316L); sealing: EPDM
Lens material	front lens:PMMA

### Displays / operating elements

Display	Switching status	1 x LED, yellow
---------	------------------	-----------------

### Accessories

Items supplied	lock nuts: 2
----------------	--------------

### Remarks

Remarks	cULus - Class 2 source required
Pack quantity	1 pcs.

### Electrical connection

Connector: 1 x M12; coding: A; Contacts: 4



### Connection

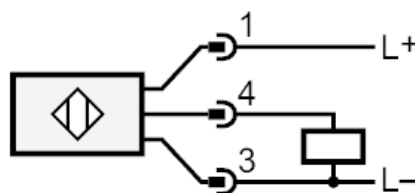

# OGE300



## Through-beam sensor receiver

OGE-DPKG/US100

### Diagrams and graphs

excess gain graph

