

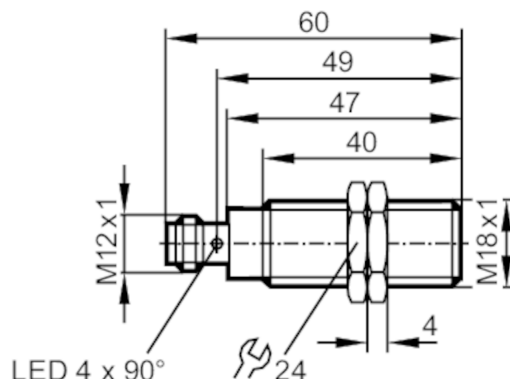

## Through-beam sensor receiver

OGE-HPKG/US100



## Product characteristics

|               |               |
|---------------|---------------|
| Type of light | red light     |
| Housing       | Threaded type |

## Application

|                    |                     |
|--------------------|---------------------|
| Function principle | Through-beam sensor |
|--------------------|---------------------|

## Electrical data

|                             |            |
|-----------------------------|------------|
| Operating voltage [V]       | 10...36 DC |
| Current consumption [mA]    | 10         |
| Protection class            | II         |
| Reverse polarity protection | yes        |
| Type of light               | red light  |
| Wave length [nm]            | 624        |

## Outputs

|  |                    |
|--|--------------------|
| Electrical design                                    | PNP                |
| Output function                                      | light-on mode      |
| Max. voltage drop switching output DC [V]            | 2.5                |
| Permanent current rating of switching output DC [mA] | 200                |
| Switching frequency DC [Hz]                          | 1000               |
| Short-circuit protection                             | yes                |
| Type of short-circuit protection                     | yes (non-latching) |
| Overload protection                                  | yes                |

## Monitoring range

|                        |          |
|------------------------|----------|
| Transmitter / receiver | receiver |
| Range [m]              | < 20     |
| Range adjustable       | no       |

## Operating conditions

|                          |          |
|--------------------------|----------|
| Ambient temperature [°C] | -25...60 |
|--------------------------|----------|



Through-beam sensor receiver

OGE-HPKG/US100

|            |       |
|------------|-------|
| Protection | IP 67 |
|------------|-------|

Tests / approvals

|              |              |
|--------------|--------------|
| EMC          | EN 60947-5-2 |
| MTTF [years] | 1067         |

Mechanical data

|                    |  |
|--------------------|--|
| Weight [g]         | 49.7                                     |
| Housing            | Threaded type                            |
| Dimensions [mm]    | M18 x 1 / L = 60                         |
| Thread designation | M18 x 1                                  |
| Material           | housing: stainless steel (1.4404 / 316L) |
| Lens material      | PMMA                                     |

Displays / operating elements

|         |                  |                 |
|---------|------------------|-----------------|
| Display | Switching status | 1 x LED, yellow |
|---------|------------------|-----------------|

Accessories

|                |              |
|----------------|--------------|
| Items supplied | lock nuts: 2 |
|----------------|--------------|

Remarks

|               |                                 |
|---------------|---------------------------------|
| Remarks       | cULus - Class 2 source required |
| Pack quantity | 1 pcs.                          |

Electrical connection

Connector: 1 x M12; coding: A

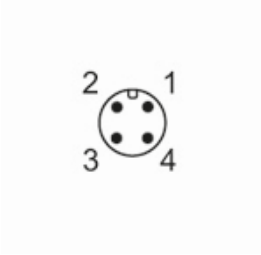

Connection

