

O8S200

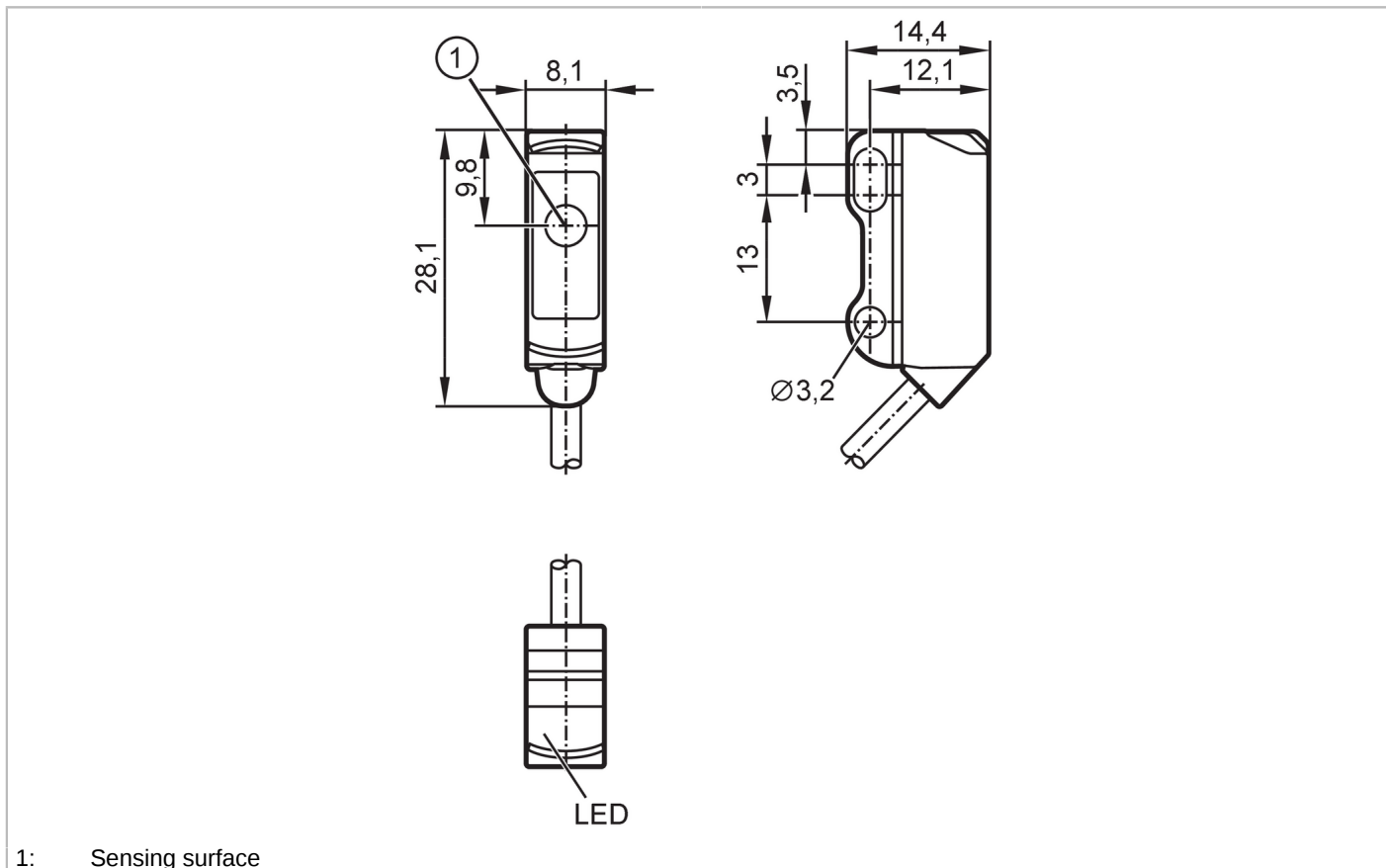

Through-beam sensor transmitter

O8S-00KG/2,0M



1: Sensing surface



Product characteristics		
Type of light		red light
Housing		rectangular
Application		
Function principle		Through-beam sensor
Application		For applications in robotics, assembly and handling technology
Electrical data		
Operating voltage	[V]	10...30 DC
Current consumption	[mA]	12; ((24 V))
Protection class		III
Reverse polarity protection		yes
Type of light		red light
Wave length	[nm]	633
Monitoring range		
Transmitter / receiver		transmitter
Range	[m]	< 3
Max. light spot diameter	[mm]	200
Light spot dimensions refer to		at maximum range
Operating conditions		
Ambient temperature	[°C]	-25...60

O8S200



Through-beam sensor transmitter

O8S-OOKG/2,0M

Protection	IP 65; IP 67
------------	--------------

Tests / approvals

EMC	EN 60947-5-2	
MTTF [years]	2912	
UL approval	Ta	-25...60 °C
	Enclosure type	Type 1
	voltage supply	Limited Voltage/Current
	UL approval number	E027
	File number UL	E174191

Mechanical data

Weight [g]	40
Housing	rectangular
Dimensions [mm]	28.1 x 8.1 x 14.4
Material	housing: ABS; rear of the housing: stainless steel (1.4404 / 316L)
Lens material	front lens:PMMA
Lens alignment	Side sensing

Displays / operating elements

Display	Switching status	1 x LED, yellow
	Power	1 x LED, green

Remarks

Pack quantity	1 pcs.
---------------	--------

Electrical connection

Cable: 2 m, PVC, black, Ø 2.9 mm; 2 x 0.08 mm²

Connection

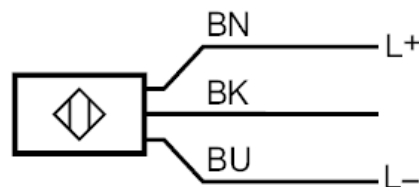

	Core colors
BN	brown
BK	black
BU	blue



Through-beam sensor transmitter

O8S-OOKG/2,0M

Diagrams and graphs

excess gain graph

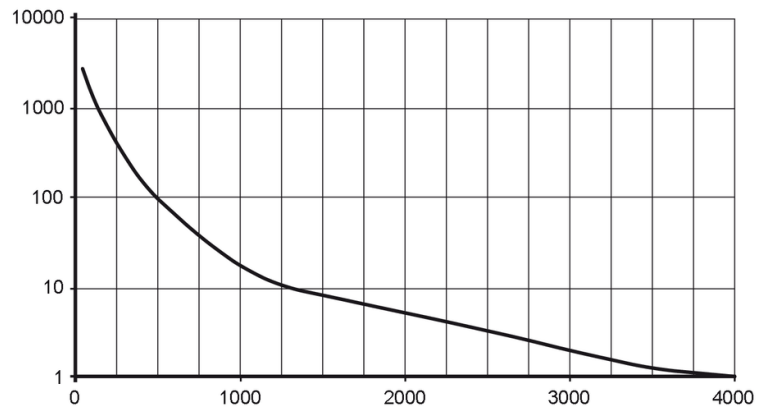

x: distance [mm]

y: excess gain factor