

O6S200

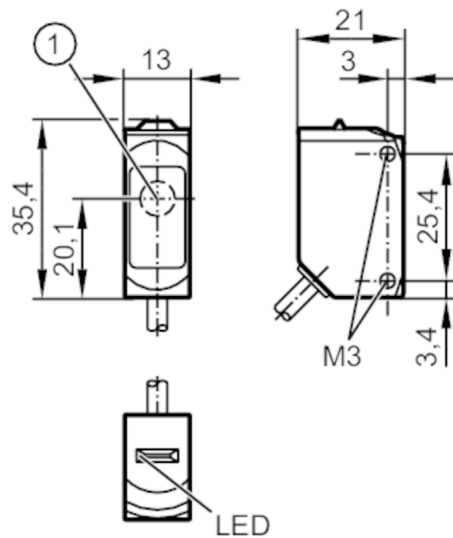

Through-beam sensor transmitter

O6S-00KG



1 Sensing surface



Product characteristics

Type of light	red light
Housing	rectangular

Application

Function principle	Through-beam sensor
--------------------	---------------------

Electrical data

Operating voltage	[V]	10...30 DC
Current consumption	[mA]	11; ((24 V))
Protection class		III
Type of light		red light
Wave length	[nm]	633

Monitoring range

Transmitter / receiver		transmitter
Range	[m]	< 10
Max. light spot diameter	[mm]	300
Light spot dimensions refer to		at maximum range

Operating conditions

Ambient temperature	[°C]	-25...60
Protection		IP 65; IP 67

Tests / approvals

EMC	EN 60947-5-2	
MTTF	[years]	2600
UL approval	UL approval number	E007

Mechanical data

Weight	[g]	56
--------	-----	----

O6S200



Through-beam sensor transmitter

O6S-00KG

Housing	rectangular
Dimensions [mm]	35.4 x 13 x 21
Material	housing: ABS; PPSU; sealing: EPDM
Lens material	PMMA
Lens alignment	Side sensing
Tightening torque [Nm]	0.5

Displays / operating elements

Display	Power	1 x LED, green
---------	-------	----------------

Remarks

Remarks	cULus - Class 2 source required
Pack quantity	1 pcs.

Electrical connection

Cable: 2 m, PUR; 2 x 0.25 mm²

Connection

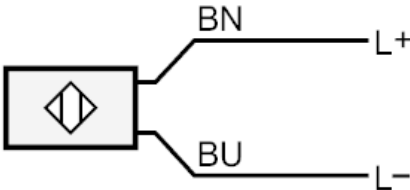

BN = Core colors : brown
BU = blue



Through-beam sensor transmitter

O6S-00KG

Diagrams and graphs

excess gain graph

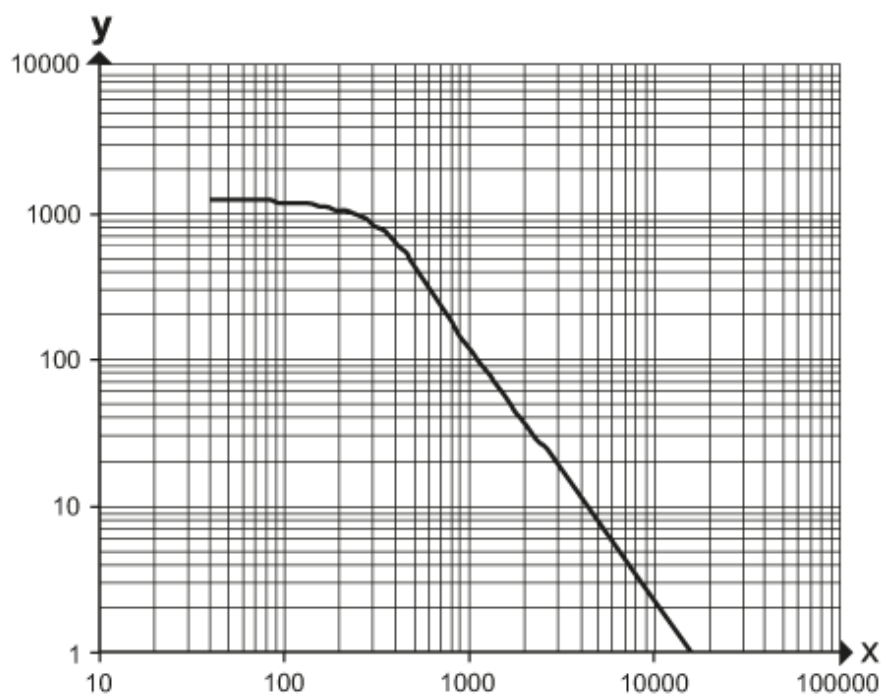

x: distance [mm]

y: excess gain factor