

N05205



Switching amplifiers for Namur sensors

NV0203 20-30VDC,OK 200Hz

Article no longer available - archive entry

Alternative articles: N0532A

When selecting an alternative article and accessories please note that technical data may differ!

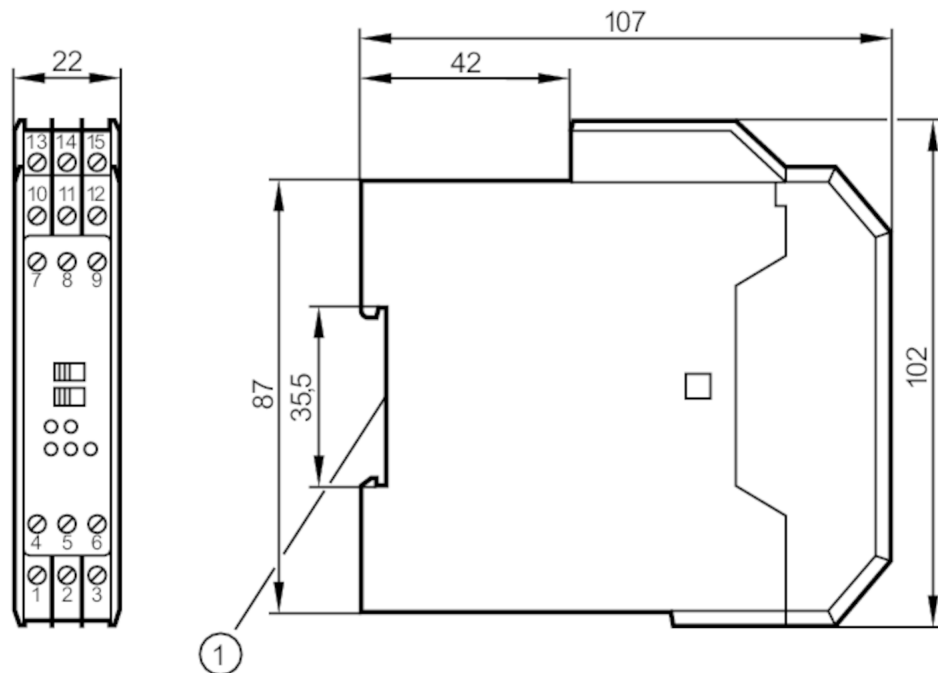

1 Mounting on DIN rail



Application

Application short-circuit monitoring; Wire break monitoring

Electrical data

Operating voltage tolerance	[%]	-15...20
Operating voltage	[V]	20...30 DC
Number of channels		2

Outputs

Electrical design	opto coupler
Switching frequency DC	[Hz] 200

Operating conditions

Ambient temperature	[°C] -20...60
Protection	IP 30
Protection rating terminals	IP 20

Tests / approvals

Approval	PTB Ex-95.C.2143X
----------	-------------------

Safety classification

Description	in protection rating intrinsic safety
-------------	---------------------------------------



Switching amplifiers for Namur sensors

NV0203 20-30VDC, OK 200Hz

Voltage	[V]	< 11
Current	[mA]	< 26
Power	[mW]	< 72
[Ex ia] IIC designation		[EEx ia] IIC
[Ex ia] IIB designation		[EEx ia] IIB
[Ex ib] IIC designation		[EEx ib] IIC
[Ex ib] IIB designation		[EEx ib] IIB
[Ex ia] IIC inductance		1mH / 2mH / 5mH
[Ex ia] IIB inductance		1mH / 2mH / 5mH
[Ex ib] IIC inductance		46mH
[Ex ib] IIB inductance		170mH
[Ex ia] IIC capacitance		567nF / 581nF / 483nF
[Ex ia] IIB capacitance		2.5μF / 2.2μF / 1.8μF
[Ex ib] IIC capacitance		2.5μF
[Ex ib] IIB capacitance		15μF

Mechanical data

Housing		housing for DIN rail mounting
Dimensions	[mm]	102 x 22 x 107

Displays / operating elements

Display	Switching status	2 x LED, yellow
	Power	LED, green
	Function	2 x LED, red

Remarks

Pack quantity	1 pcs.
---------------	--------

Electrical connection

terminals: 15 x ...2.5 mm²

Connection

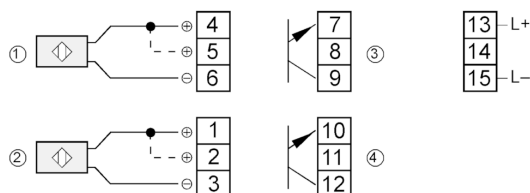

- 1: sensor 1
 2: sensor 2
 3: Output 1
 4: Output 2
 bridge 4-5 / 1-2 = without wire-break monitoring