



Capacitive sensor

KI-3015-FPKG/NI/SS-000-K

Article no longer available - archive entry

Alternative articles: KI6000

When selecting an alternative article and accessories please note that technical data may differ!

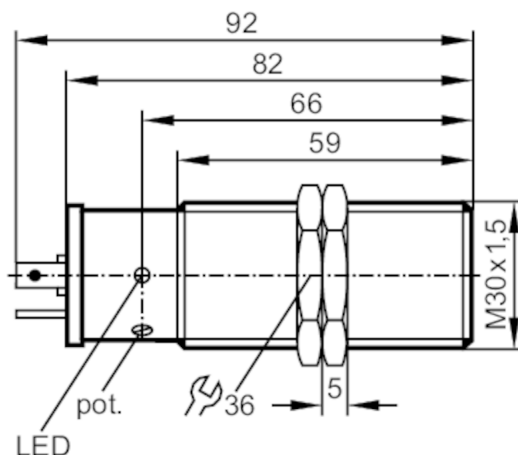

Product characteristics

Electrical design	PNP
Output function	normally open / closed; (selectable)
Sensing range [mm]	3...15
Housing	Threaded type
Dimensions [mm]	M30 x 1.5 / L = 92

Electrical data

Operating voltage [V]	10...36 DC
Current consumption [mA]	13; (24 V)
Protection class	III
Reverse polarity protection	yes

Outputs

Electrical design	PNP
Output function	normally open / closed; (selectable)
Max. voltage drop switching output DC [V]	2.5
Permanent current rating of switching output DC [mA]	250
Switching frequency DC [Hz]	40
Short-circuit proof	yes
Overload protection	yes

Monitoring range

Sensing range [mm]	3...15
Sensing range adjustable	yes

KI5206



Capacitive sensor

KI-3015-FPKG/NI/SS-000-K

Factory setting sensing range [mm]	15
------------------------------------	----

Operating conditions

Ambient temperature [°C]	-25...70
Protection	IP 65
Increased immunity	yes; (Increased immunity to conducted radio frequency interference)

Tests / approvals

EMC	EN 60947-5-2
-----	--------------

Mechanical data

Weight [g]	102.6
Housing	Threaded type
Mounting	non-flush mountable
Dimensions [mm]	M30 x 1.5 / L = 92
Thread designation	M30 x 1.5
Material	PBT

Displays / operating elements

Display	Switching status	1 x LED, yellow
---------	------------------	-----------------

Accessories

Items supplied	lock nuts: 2
	screwdriver: 1

Remarks

Pack quantity	1 pcs.
---------------	--------

Electrical connection - plug

Connector: 1 x valve plug type A DIN (DIN EN 175301-803)



Connection

