

# IN5364

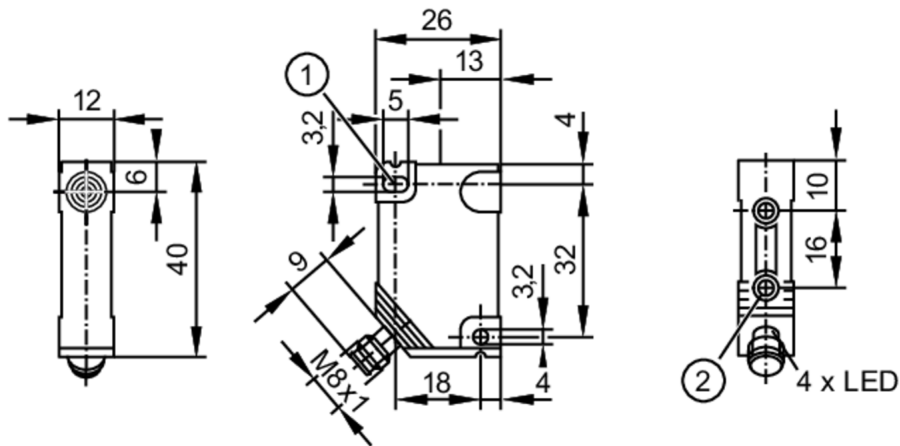

## Inductive sensor

IN-3002-APKG/AS-514-TPO



- 1 mounting hole  
2 threaded bush M3 Depth 5.8 mm



### Product characteristics

Electrical design	PNP
Output function	normally closed
Sensing range [mm]	2
Housing	rectangular
Dimensions [mm]	40 x 12 x 26

### Electrical data

Operating voltage [V]	10...36 DC
Current consumption [mA]	15; (24 V)
Protection class	III
Reverse polarity protection	yes

### Outputs

Electrical design	PNP
Output function	normally closed
Max. voltage drop switching output DC [V]	2.5
Permanent current rating of switching output DC [mA]	250
Switching frequency DC [Hz]	1400
Short-circuit protection	yes
Type of short-circuit protection	yes (non-latching)
Overload protection	yes

### Monitoring range

Sensing range [mm]	2
Real sensing range Sr [mm]	2 ± 10 %
Operating distance [mm]	0...1.6

# IN5364



## Inductive sensor

IN-3002-APKG/AS-514-TPO

Accuracy / deviations		
Correction factor	steel: 1 / stainless steel: 0.7 / brass: 0.5 / aluminum: 0.4 / copper: 0.3	
Hysteresis	[% of Sr]	3...15
Switch-point drift	[% of Sr]	-10...10
Operating conditions		
Ambient temperature	[°C]	-25...80
Protection		IP 65
Tests / approvals		
EMC	EN 60947-5-2	
MTTF	[years]	1906
Mechanical data		
Weight	[g]	20
Housing		rectangular
Mounting		flush mountable
Dimensions	[mm]	40 x 12 x 26
Material		PBT
Mounting hole		
Tightening torque	[Nm]	< 0.5
Threaded bush		
Tightening torque	[Nm]	< 1.2; (when brass insert in contact with counterpart)
Displays / operating elements		
Display	Switching status	4 x 90° LED, yellow
Remarks		
Pack quantity		1 pcs.
Electrical connection - plug		
Connector: 1 x M8; coding: A		

# IN5364



## Inductive sensor

IN-3002-APKG/AS-514-TPO

### Connection

