



Inductive sensor

IN-3002-BNOG

Article no longer available - archive entry

Alternative articles: IN5269

When selecting an alternative article and accessories please note that technical data may differ!

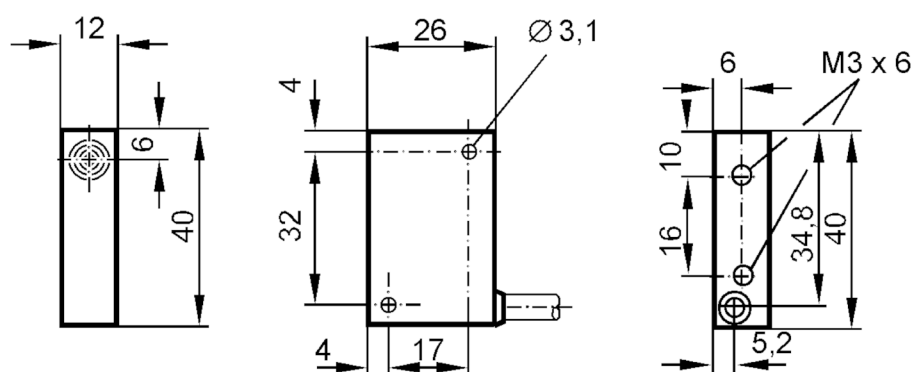

Product characteristics

Electrical design		NPN
Output function		normally closed
Sensing range	[mm]	2
Housing		rectangular
Dimensions	[mm]	40 x 12 x 26

Electrical data

Operating voltage	[V]	10...30 DC
Current consumption	[mA]	15; (24 V)
Reverse polarity protection		no

Outputs

Electrical design		NPN
Output function		normally closed
Max. voltage drop switching output DC	[V]	1
Permanent current rating of switching output DC	[mA]	200
Switching frequency DC	[Hz]	250
Short-circuit protection		no
Overload protection		no

Monitoring range

Sensing range	[mm]	2
---------------	------	---

IN5003



Inductive sensor

IN-3002-BNOG

Real sensing range Sr	[mm]	2 ± 10 %
Operating distance	[mm]	0...1.6

Accuracy / deviations		
Correction factor		steel: 1 / stainless steel: 0.85 / brass: 0.54 / aluminum: 0.5 / copper: 0.46
Hysteresis	[% of Sr]	3...10
Switch-point drift	[% of Sr]	-10...10

Operating conditions		
Ambient temperature	[°C]	-25...80
Protection		IP 65

Mechanical data		
Housing		rectangular
Mounting		flush mountable
Dimensions	[mm]	40 x 12 x 26
Material		PBT

Remarks		
Pack quantity		1 pcs.

Electrical connection

Cable: 2 m, PVC; 3 x 0.5 mm²

Connection

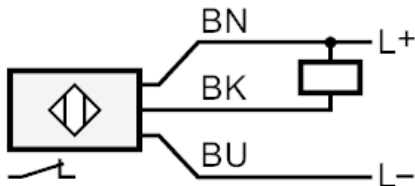

	Core colors :
BK =	black
BN =	brown
BU =	blue