

# IN5426

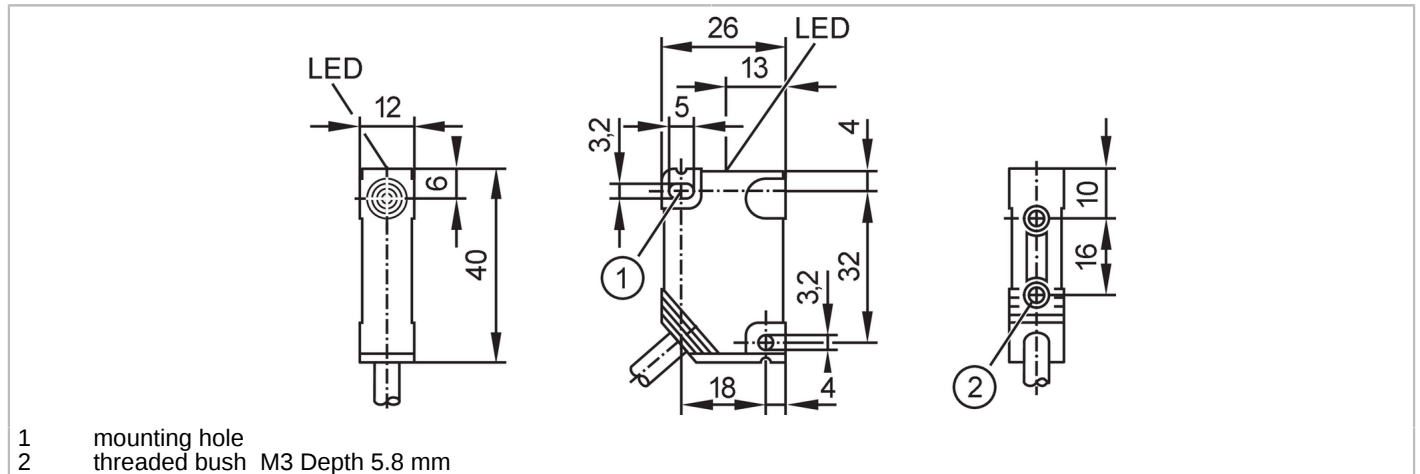

## Inductive sensor

IN-2004-FRKG/PH



Product characteristics	
Electrical design	PNP/NPN
Output function	normally open / closed; (selectable)
Sensing range [mm]	4
Housing	rectangular
Dimensions [mm]	40 x 12 x 26
Electrical data	
Operating voltage [V]	10...36 DC
Protection class	II
Reverse polarity protection	yes
Outputs	
Electrical design	PNP/NPN
Output function	normally open / closed; (selectable)
Max. voltage drop switching output DC [V]	4.6
Minimum load current [mA]	4
Max. leakage current [mA]	0.5
Permanent current rating of switching output DC [mA]	100
Switching frequency DC [Hz]	1200
Short-circuit protection	yes
Type of short-circuit protection	yes (non-latching)
Overload protection	yes
Monitoring range	
Sensing range [mm]	4
Real sensing range $S_r$ [mm]	$4 \pm 10\%$
Operating distance [mm]	0...3.25
Accuracy / deviations	
Correction factor	steel: 1 / stainless steel: 0.7 / brass: 0.4 / aluminum: 0.4 / copper: 0.3

# IN5426



## Inductive sensor

IN-2004-FRKG/PH

Hysteresis	[% of Sr]	1...15
Switch-point drift	[% of Sr]	-10...10

### Operating conditions

Ambient temperature	[°C]	-25...80
Protection		IP 65; IP 66; IP 67

### Tests / approvals

EMC	EN 61000-4-2 ESD	- kV CD / 8 kV AD
	EN 61000-4-3 HF radiated	10 V/m
	EN 61000-4-4 Burst	2 kV
	EN 61000-4-5 Surge	0,5 kV line to line, Ri: 2 Ohm
	EN 61000-4-6 HF conducted	10 V
	EN 55011 emission	class B
MTTF	[years]	2252

### Mechanical data

Weight	[g]	98.4
Housing		rectangular
Mounting		non-flush mountable
Dimensions	[mm]	40 x 12 x 26
Material		housing: PBT

Mounting hole		
Tightening torque	[Nm]	< 0.5
Threaded bush		
Tightening torque	[Nm]	< 1.2; (when brass insert in contact with counterpart)

### Displays / operating elements

Display	Switching status	1 x LED, yellow
---------	------------------	-----------------

### Remarks

Pack quantity		1 pcs.
---------------	--	--------

# IN5426



## Inductive sensor

IN-2004-FRKG/PH

### Electrical connection

Cable: 2 m, PUR; 2 x 0.5 mm<sup>2</sup>

### Connection

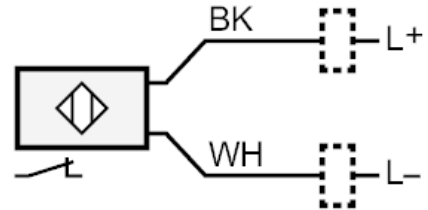
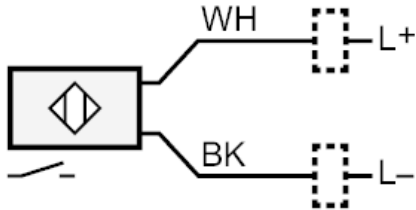

Core colors :  
BN = brown  
BU = blue  
BK = black  
WH = white