

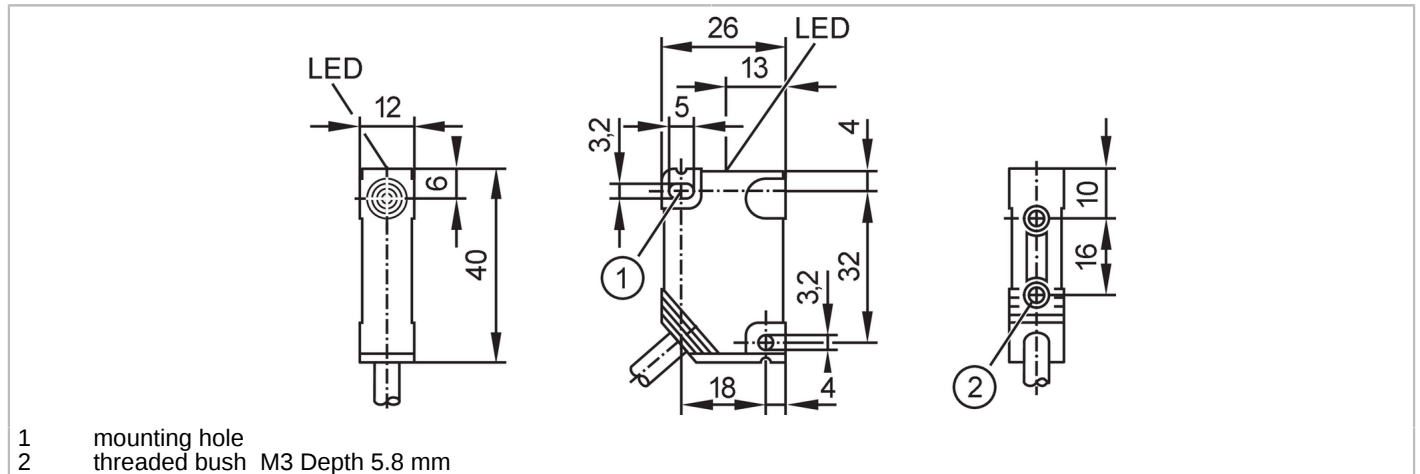

Inductive sensor

IN-2002-ABOA



Product characteristics		
Output function		normally open
Sensing range	[mm]	2
Housing		rectangular
Dimensions	[mm]	40 x 12 x 26
Electrical data		
Operating voltage	[V]	20...250 AC/DC
Protection class		II
Reverse polarity protection		yes
Outputs		
Output function		normally open
Max. voltage drop switching output DC	[V]	6
Max. voltage drop switching output AC	[V]	6.7
Minimum load current	[mA]	5
Max. leakage current	[mA]	2.0 (250 V AC) / 1.3 (110 V AC) / 0.8 (24 V DC)
Permanent current rating of switching output AC	[mA]	250; (350 (...50 °C))
Permanent current rating of switching output DC	[mA]	100
Short-time current rating of switching output	[mA]	2200; (50 ms / 1 Hz)
Switching frequency AC	[Hz]	25
Switching frequency DC	[Hz]	50
Short-circuit proof		no
Overload protection		no
Monitoring range		
Sensing range	[mm]	2
Real sensing range Sr	[mm]	2 ± 10 %
Operating distance	[mm]	0...1.6

IN0097



Inductive sensor

IN-2002-ABOA

Accuracy / deviations		
Correction factor		steel: 1 / stainless steel: 0.7 / brass: 0.25 / aluminum: 0.2 / copper: 0.05
Hysteresis	[% of Sr]	1...20
Switch-point drift	[% of Sr]	-10...10
Operating conditions		
Ambient temperature	[°C]	-25...80
Protection		IP 67
Tests / approvals		
EMC	EN 61000-4-2 ESD	4 kV CD / 8 kV AD
	EN 61000-4-3 HF radiated	3 V/m
	EN 61000-4-4 Burst	2 kV
	EN 61000-4-6 HF conducted	3 V
	EN 55011 emission	class B
MTTF	[years]	609
CSA approval	Ta	-25...60 °C
	Classification	Class I; Div. 2; Groups A, B, C, D; T4
		Class II; Div. 2; Groups F, G; T135 °C
		Class III
Mechanical data		
Weight	[g]	104.8
Housing		rectangular
Mounting		flush mountable
Dimensions	[mm]	40 x 12 x 26
Material		housing: PBT
Mounting hole		
Tightening torque	[Nm]	< 0.5
Threaded bush		
Tightening torque	[Nm]	< 1.2; (when brass insert in contact with counterpart)
Displays / operating elements		
Display	Switching status	1 x LED, yellow
Electrical connection		
Required protection		miniature fuse to IEC60127-2 sheet 1; ≤ 2 A; fast acting
Remarks		
Remarks		Recommendation: check the unit for reliable function after a short circuit.
Pack quantity		1 pcs.

IN0097



Inductive sensor

IN-2002-ABOA

Electrical connection

Cable: 2 m, PVC; 2 x 0.5 mm²

Connection

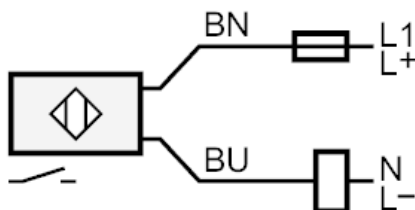

Note miniature fuse to IEC60127-2 sheet 1 \leq 2 A fast acting

Core colors :

BN =

brown

BU =

blue