

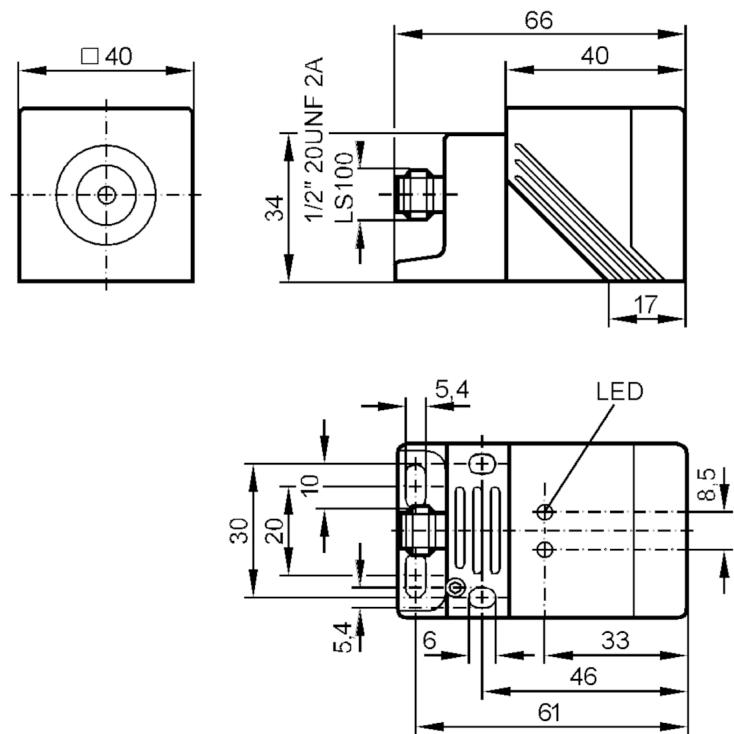

Inductive sensor

IMC2035-BBOA/SL/LS-100AK



| Product characteristics                         |      |   |
|---|------|---|
| Output function                                 |      | normally closed                                 |
| Sensing range                                   | [mm] | 35  |
| Housing   |      | rectangular                                     |
| Application                                     |      |   |
| System  |      | Increased sensing range                         |
| Electrical data                                 |      |   |
| Operating voltage                               | [V]  | 20...250 AC/DC                                  |
| Protection class                                |      | I   |
| Reverse polarity protection                     |      | no  |
| Outputs   |      |   |
| Output function                                 |      | normally closed                                 |
| Max. voltage drop switching output DC           | [V]  | 6   |
| Max. voltage drop switching output AC           | [V]  | 6.5   |
| Minimum load current                            | [mA] | 1.9   |
| Max. leakage current                            | [mA] | 2.5 (250 V AC) / 1.3 (130 V AC) / 0.8 (24 V DC) |
| Permanent current rating of switching output AC | [mA] | 250; (350 (...50 °C))                           |
| Permanent current rating of switching output DC | [mA] | 100   |
| Short-time current rating of switching output   | [mA] | 2200; (20 ms / 0,5 Hz)                          |

# IM0057



## Inductive sensor

IMC2035-BBOA/SL/LS-100AK

|                                      |                  |   |
|--------------------------------------|------------------|---|
| Switching frequency AC               | [Hz]             | 20  |
| Switching frequency DC               | [Hz]             | 50  |
| Short-circuit proof                  |                  | no  |
| Overload protection                  |                  | no  |
| <b>Monitoring range</b>              |                  |   |
| Sensing range                        | [mm]             | 35  |
| Operating distance                   | [mm]             | 0...28.3  |
| Increased sensing range              |                  | yes   |
| <b>Accuracy / deviations</b>         |                  |   |
| Correction factor                    |                  | steel: 1 / stainless steel: 0.7 / brass: 0.4 / aluminum: 0.4 / copper: 0.3                      |
| Hysteresis                           | [% of Sr]        | 3...15  |
| <b>Operating conditions</b>          |                  |   |
| Ambient temperature                  | [°C]             | -25...70  |
| Protection                           |                  | IP 67   |
| <b>Tests / approvals</b>             |                  |   |
| EMC                                  | EN 60947-5-2     |   |
|                                      | EN 55011         | class B   |
| MTTF                                 | [years]          | 600   |
| <b>Mechanical data</b>               |                  |   |
| Weight                               | [g]              | 164   |
| Housing                              |                  | rectangular   |
| Mounting                             |                  | non-flush mountable   |
| Material                             |                  | housing: PPE; sensing face: PPE orange; end cap: PPS; clamp: PPS black; screw: steel galvanized |
| <b>Displays / operating elements</b> |                  |   |
| Display                              | Switching status | 1 x LED, yellow   |
| <b>Electrical connection</b>         |                  |   |
| Required protection                  |                  | miniature fuse to IEC60127-2 sheet 1; ≤ 2 A; fast acting  |
| <b>Remarks</b>                       |                  |   |
| Remarks                              |                  | Recommendation: check the unit for reliable function after a short circuit.                     |
|                                      |                  | 5 positions of the active zone possible   |
| Pack quantity                        |                  | 1 pcs.  |

# IM0057



## Inductive sensor

IMC2035-BBOA/SL/LS-100AK

### Electrical connection - plug

Connector: 1 x 1/2"; coding: C; Locking: brass, white bronze coated

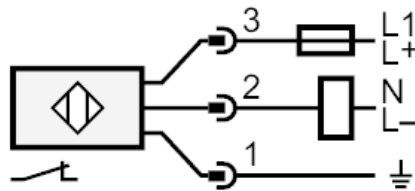

Note miniature fuse to IEC60127-2 sheet 1  $\leq 2$  A fast acting