



Inductive sensor

IIB3015-BNOG/MS

Article no longer available - archive entry

Alternative articles: II5346

When selecting an alternative article and accessories please note that technical data may differ!

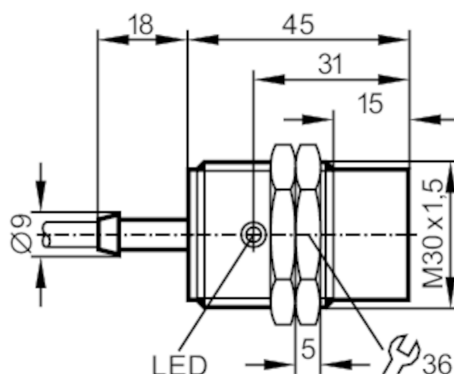

Product characteristics

Electrical design	NPN
Output function	normally closed
Sensing range [mm]	15
Housing	Threaded type
Dimensions [mm]	M30 x 1.5 / L = 45

Electrical data

Operating voltage [V]	18...36 DC
Current consumption [mA]	7; (24 V)
Protection class	II
Reverse polarity protection	no

Outputs

Electrical design	NPN
Output function	normally closed
Max. voltage drop switching output DC [V]	2
Permanent current rating of switching output DC [mA]	200
Switching frequency DC [Hz]	250
Short-circuit protection	no
Overload protection	no

Monitoring range

Sensing range [mm]	15
Real sensing range Sr [mm]	15 ± 10 %
Operating distance [mm]	0...12.1

Accuracy / deviations

Correction factor	steel: 1 / stainless steel: 0.7 / brass: 0.4 / aluminum: 0.3 / copper: 0.2
Hysteresis [% of Sr]	1...15



Inductive sensor

IIB3015-BNOG/MS

Switch-point drift	[% of Sr]	-10...10
--------------------	-----------	----------

Operating conditions

Ambient temperature	[°C]	-25...80
Protection		IP 67

Mechanical data

Housing		Threaded type
Mounting		non-flush mountable
Dimensions	[mm]	M30 x 1.5 / L = 45
Thread designation		M30 x 1.5
Material		brass nickel-plated; PBT

Displays / operating elements

Display	Switching status	1 x LED, yellow
---------	------------------	-----------------

Accessories

Items supplied		lock nuts: 2
----------------	--	--------------

Remarks

Pack quantity		1 pcs.
---------------	--	--------

Electrical connection

Cable: 2 m, PVC; 3 x 0.5 mm²

Connection

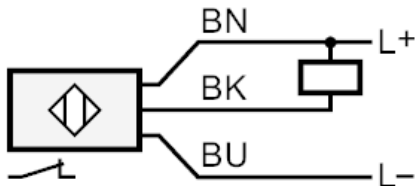

BK = Core colors :
BN = black
BU = brown
blue