

# IF5840



## Inductive sensor

IFK3003BBPKG/V4A/30M

Article to be discontinued

Alternative articles: IF5837

When selecting an alternative article and accessories please note that technical data may differ!

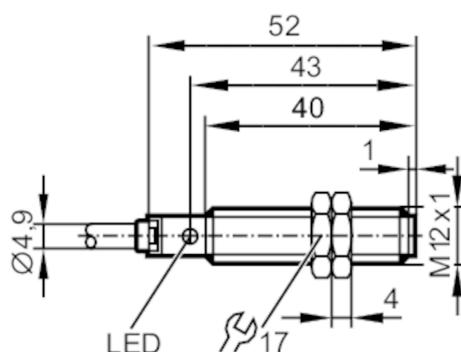

### Product characteristics

Electrical design	PNP
Output function	normally open
Sensing range [mm]	3
Housing	Threaded type
Dimensions [mm]	M12 x 1

### Electrical data

Operating voltage [V]	10...36 DC
Current consumption [mA]	15; (24 V)
Protection class	III
Reverse polarity protection	yes

### Outputs

Electrical design	PNP
Output function	normally open
Max. voltage drop switching output DC [V]	2.5
Permanent current rating of switching output DC [mA]	200
Switching frequency DC [Hz]	400
Short-circuit protection	yes
Type of short-circuit protection	yes (non-latching)
Overload protection	yes

### Monitoring range

Sensing range [mm]	3
Real sensing range $S_r$ [mm]	$3 \pm 10\%$
Operating distance [mm]	0...2.4

# IF5840



## Inductive sensor

IFK3003BBPKG/V4A/30M

Accuracy / deviations		
Correction factor	steel: 1 / stainless steel: 0.7 / brass: 0.5 / aluminum: 0.4 / copper: 0.3	
Hysteresis	[% of Sr]	3...15
Switch-point drift	[% of Sr]	-10...10
Operating conditions		
Ambient temperature	[°C]	-25...80
Protection		IP 67
Tests / approvals		
EMC	EN 60947-5-2	
	EN 55011	class B
MTTF	[years]	1874
Mechanical data		
Weight	[g]	1041.2
Housing		Threaded type
Mounting		flush mountable
Dimensions	[mm]	M12 x 1
Thread designation		M12 x 1
Material		stainless steel (1.4571/316Ti ); PBT
Displays / operating elements		
Display	Switching status	1 x LED, yellow
Accessories		
Items supplied		lock nuts: 2
Remarks		
Pack quantity		1 pcs.
Electrical connection		
Cable: 30 m, PVC; 3 x 0.34 mm <sup>2</sup>		
Connection		

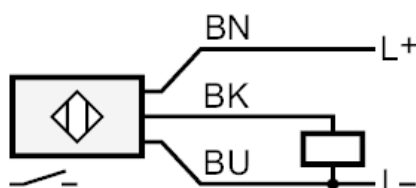

	Core colors :
BK =	black
BN =	brown
BU =	blue