



## Inductive sensor

IFK3004-APOG/US-100/MDG/OLED

Article no longer available - archive entry

Alternative articles: IFC207

When selecting an alternative article and accessories please note that technical data may differ!

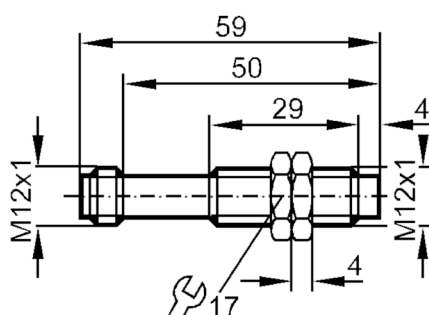

## Product characteristics

Electrical design	PNP
Output function	normally closed
Sensing range [mm]	4
Housing	Threaded type
Dimensions [mm]	M12 x 1

## Electrical data

Operating voltage [V]	10...30 DC
Current consumption [mA]	15; (24 V)
Protection class	II
Reverse polarity protection	no

## Outputs

Electrical design	PNP
Output function	normally closed
Max. voltage drop switching output DC [V]	1
Permanent current rating of switching output DC [mA]	200
Switching frequency DC [Hz]	300
Short-circuit protection	no
Overload protection	no

# IF5509



## Inductive sensor

IFK3004-APOG/US-100/MDG/OLED

Monitoring range		
Sensing range	[mm]	4
Real sensing range Sr	[mm]	4 ± 10 %
Operating distance	[mm]	0...3.25
Accuracy / deviations		
Correction factor		steel: 1 / stainless steel: 0.7 / brass: 0.4 / aluminum: 0.3 / copper: 0.2
Hysteresis	[% of Sr]	1...15
Switch-point drift	[% of Sr]	-10...10
Operating conditions		
Ambient temperature	[°C]	-25...80
Protection		IP 67
Tests / approvals		
EMC	EN 60947-5-2	
Mechanical data		
Housing		Threaded type
Mounting		non-flush mountable
Dimensions	[mm]	M12 x 1
Thread designation		M12 x 1
Material		brass nickel-plated; PBT
Accessories		
Items supplied		lock nuts: 2
Remarks		
Pack quantity		1 pcs.
Electrical connection - plug		
Connector: 1 x M12; coding: A		
		

# IF5509



## Inductive sensor

IFK3004-APOG/US-100/MDG/OLED

### Connection

