

# IE5379

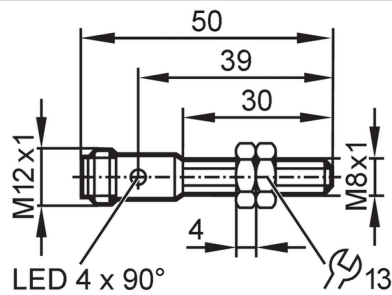

## Inductive sensor

IEB3002BBPKG/V4A/US-104



### Product characteristics

Electrical design		PNP
Output function		normally open
Sensing range	[mm]	2
Housing		Threaded type
Dimensions	[mm]	M8 x 1 / L = 50

### Application

Special feature		Increased sensing range
-----------------	--	-------------------------

### Electrical data

Operating voltage	[V]	10...30 DC
Current consumption	[mA]	< 10
Protection class		III
Reverse polarity protection		yes

### Outputs

Electrical design		PNP
Output function		normally open
Max. voltage drop switching output DC	[V]	2.5
Permanent current rating of switching output DC	[mA]	100
Switching frequency DC	[Hz]	1000
Short-circuit protection		yes
Overload protection		yes

### Monitoring range

Sensing range	[mm]	2
Real sensing range Sr	[mm]	2 ± 10 %
Operating distance	[mm]	0...1.62
Increased sensing range		yes

### Accuracy / deviations

Correction factor		steel: 1 / stainless steel: 0.7 / brass: 0.5 / aluminum: 0.4 / copper: 0.3
Hysteresis	[% of Sr]	1...20
Switch-point drift	[% of Sr]	-10...10

### Operating conditions

Ambient temperature	[°C]	0...100
---------------------	------	---------

# IE5379



## Inductive sensor

IEB3002BBPKG/V4A/US-104

Protection	IP 68; IP 69K
------------	---------------

### Tests / approvals

EMC	EN 61000-4-2 ESD	4 kV CD / 8 kV AD
	EN 61000-4-3 HF radiated	3 V/m
	EN 61000-4-4 Burst	2 kV
	EN 61000-4-6 HF conducted	3 V
	EN 55011	class B
MTTF [years]		1393
UL approval	Ta	0...70 °C
	Enclosure type	Type 1
	voltage supply	Limited Voltage/Current
	UL approval number	A030
	File number UL	E174191

### Mechanical data

Weight [g]	21
Housing	Threaded type
Mounting	flush mountable
Dimensions [mm]	M8 x 1 / L = 50
Thread designation	M8 x 1
Material	stainless steel (1.4404 / 316L); sensing face: LCP white; LED window: PEI; lock nuts: stainless steel (1.4404 / 316L)
Tightening torque [Nm]	A = 5 mm: 2 Nm; B: 5 Nm
Full-metal housing	no

### Displays / operating elements

Display	Switching status	4 x 90° LED, yellow
---------	------------------	---------------------

### Accessories

Items supplied	lock nuts: 2
----------------	--------------

### Remarks

Pack quantity	1 pcs.
---------------	--------

### Electrical connection - plug

Connector: 1 x M12; coding: A; Contacts: 3



# IE5379



## Inductive sensor

IEB3002BBPKG/V4A/US-104

### Connection



### Diagrams and graphs

#### Installation

