

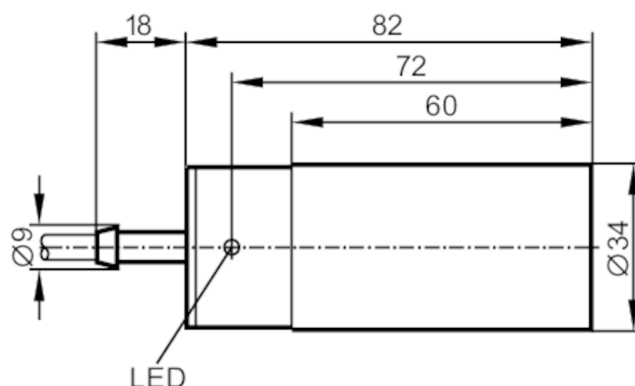

Inductive sensor

IB-2020SFROG/10m

Article no longer available - archive entry



Product characteristics

Electrical design	PNP; (Self-monitoring system)
Output function	normally open / closed; (selectable)
Sensing range [mm]	20
Housing	tubular
Dimensions [mm]	Ø 34 / L = 82

Electrical data

Connection at circuit amplifier	yes
Switching amplifiers	Connection to F400 control monitor or as 2-wire DC DNP
Operating voltage [V]	10...55 DC
Reverse polarity protection	no

Outputs

Electrical design	PNP; (Self-monitoring system)
Output function	normally open / closed; (selectable)
Max. voltage drop switching output DC [V]	6.5
Minimum load current [mA]	5
Max. leakage current [mA]	1.5
Permanent current rating of switching output DC [mA]	50
Switching frequency DC [Hz]	20
Short-circuit protection	no
Overload protection	no

Monitoring range

Sensing range [mm]	20
Real sensing range Sr [mm]	20 ± 10 %
Operating distance [mm]	0...16.2

Accuracy / deviations

Correction factor	steel: 1 / stainless steel: 0.7 / brass: 0.4 / aluminum: 0.3 / copper: 0.2
Hysteresis [% of Sr]	1...15

IB5022



Inductive sensor

IB-2020SFROG/10m

Switch-point drift	[% of Sr]	-10...10
Operating conditions		
Ambient temperature	[°C]	-25...80
Protection		IP 67
Tests / approvals		
EMC	EN 60947-5-2	
	EN 55011	class B
Mechanical data		
Housing		tubular
Mounting		non-flush mountable
Dimensions	[mm]	Ø 34 / L = 82
Material		PBT; end cap: PC
Displays / operating elements		
Display	Switching status	1 x LED, yellow
Accessories		
Items supplied		Mounting clamp: 1
Remarks		
Pack quantity		1 pcs.



Inductive sensor

IB-2020SFROG/10m

Electrical connection

Cable: 10 m, PVC; 3 x 0.5 mm²

Connection

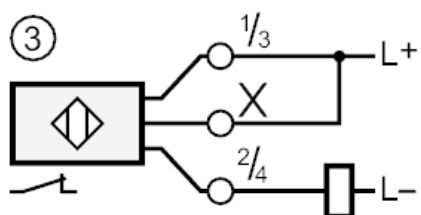
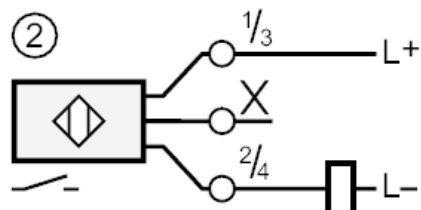
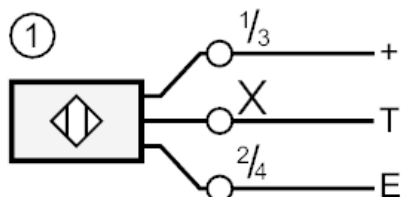

- 1 = connection to F400
 2 = Connection 2-wire DC
 3 = Connection 2-wire DC
 Core colors :
 BK = black
 BN = brown
 BU = blue