

PNP / NPN inverter module

Converter PNP-NPN SIGNAL PIN 2

Please see the technical note under "Downloads"

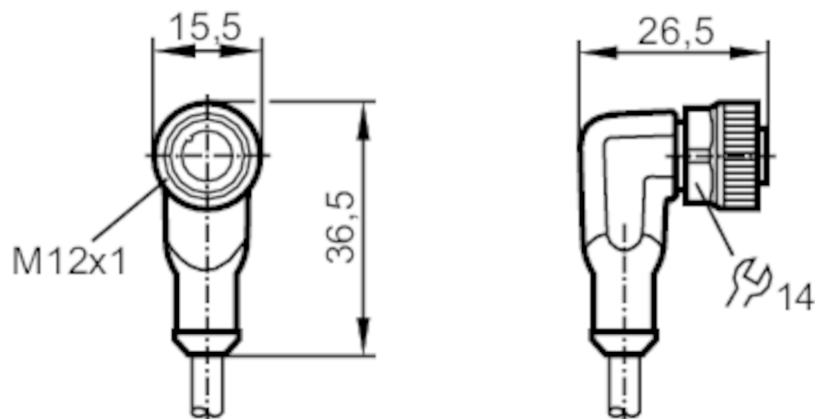

Application

System	Halogen-free; gold-plated contacts; Drag chain suitability
Compatible with paint	yes

Electrical data

Operating voltage tolerance	[%]	10
Operating voltage	[V]	< 24 DC
Protection class		II
Max. current load total	[A]	0.1

Outputs

Max. voltage drop switching output DC	[V]	2
---------------------------------------	-----	---

Operating conditions

Ambient temperature	[°C]	-25...60
Ambient temperature (moving)	[°C]	-25...60
Protection		IP 65; IP 67; IP 68; IP 69K

Mechanical data

Weight	[g]	179
Dimensions	[mm]	26.5 x 15.5 x 36.5
Material		housing: TPU (urethane) black; sealing: FKM
Material nut		brass, nickel-plated
Drag chain suitability		yes



PNP / NPN inverter module

Converter PNP-NPN SIGNAL PIN 2

Drag chain suitability	Bending radius for flexible applications	min. 10 x cable diameter
	Travel speed	max. 3.3 m/s for a horizontal travel length of 5 m and max. acceleration of 5 m/s²
	Bending cycles	> 5 Mio.
	Torsional strain	± 180 °/m

Remarks	
Remarks	for sensors to IEC 60947-5-2 with normally closed operation
Notes	Please see the technical note under "Downloads"
Pack quantity	1 pcs.

Electrical connection

Cable: 5 m, PUR, Halogen-free, black, Ø 4.3 mm; 4 x 0.34 mm² (42 x Ø 0.1 mm)

Electrical connection - Socket

Connector: 1 x M12, angled; coding: A; Locking: brass, nickel-plated; Contacts: gold-plated; Tightening torque: 0.6...1.5 Nm

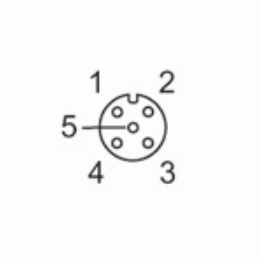

Connection

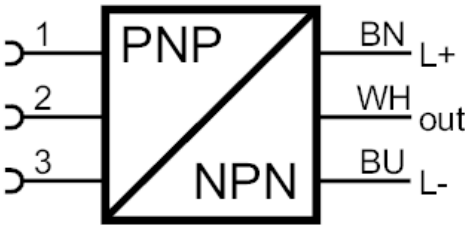

	Core colors :
BK =	black
BN =	brown
BU =	blue
WH =	white