

# E43310

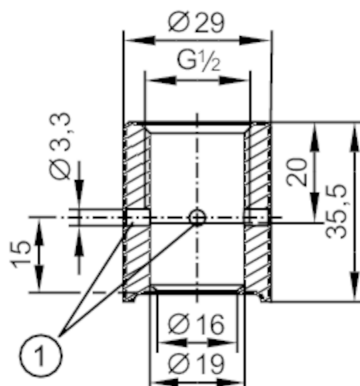

## Welding adapter for process sensors

ADAPT G1/2-WELD FOR PIPE 3A



1 Leakage port



EC 1935/2004 EHEDG Certified FCM FDA

### Application

Design	for pipes, with leakage port (3A)
Pressure rating [bar]	50
Note on pressure rating	for the connection sensor - adapter

### Tests / approvals

Pressure equipment directive	A possible classification to PED depends on the application and has to be carried out by the user / operator.
Safety instructions	The compatibility between medium and product material has to be checked in all applications.

### Mechanical data

Weight [g]	160
Material	stainless steel (1.4435 / 316L)
Sensor connection	G 1/2 sealing cone
Process connection	Welding adapter Ø 29 mm
Surface characteristics Ra/Rz of the wetted parts	0.4 / 4

### Accessories

Items supplied	O-rings:, FKM
----------------	---------------

### Remarks

Pack quantity	1 pcs.
---------------	--------